

- Flashing and Static Beacons p11-1
- Xenon Strobe Beacons p11-9
- Rotating Beacons p11-17
- Sounders and Sounder Beacons p11-21
- Speech and Tone Sounders p11-43
- Motor Sirens p11-44
- Buzzers and Horns p11-49
- Bells p11-52
- Hand Operated Sirens and Horns p11-53
- Marine Beacons and Sounders p11-54
- Loud Speakers p11-57
- Traffic Lights and Status Indicators p11-58
- Aircraft Warning Lights p11-62

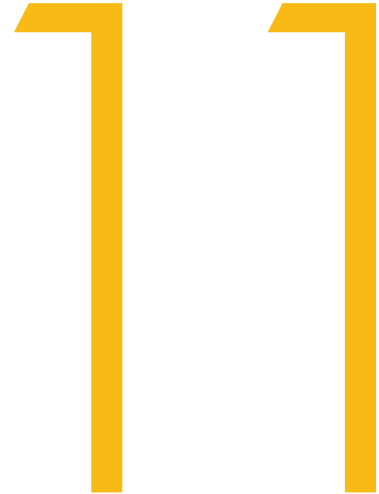

Microlamp

- High output LED or incandescent bulb
- Steady or flashing light
- Audible signal option with continuous or intermittent sound
- Multi-voltage
- Double insulated
- IP54 (IP30 with audible option)



Microlamp



Microlamp A

Order Code	Voltage	Current	Weight (kg)
Microlamp LED			
continuous or triple flash – selectable by terminals			
SIR15L0240*	12-24VAC/DC ±10%	180mA	0.12
SIR15L0480*	48VAC/DC ±10%	115mA	0.12
SIR15L2400*	90-240VAC ±10%	40mA	0.12
Microlamp A LED with audible signal			
continuous or pulsing in synchronisation with the light			
SIR603L024*	12-24VAC/DC ±10%	180mA	0.19
SIR603L048*	48VAC/DC ±10%	115mA	0.19
SIR603L240*	90-240VAC ±10%	40mA	0.19
Microlamp L MT (bulb must be ordered separately)			
Continuous or flashing – selectable by terminals			
SIR1504840*	12-48VDC	420-105mA	0.12
SIR1524040*	24-240VAC	215-20mA	0.12

*Specify colour A = Amber, B = Blue, C = Clear, G = Green, R = Red, Y = Yellow

Order Code	Voltage	Luminous Intensity	
Bulbs – BA15D 5W			
Bulb MUST be ordered separately to suit operating voltage			
SIR3906012	12V	25Cd(p)	
SIR3906024	24V	18Cd(p)	
SIR3906048	48V	8Cd(p)	
SIR3906110	110V	3Cd(p)	
SIR3906240	240V	2Cd(p)	
Microlamp A FCL (supplied with bulb) with audible			
continuous or pulsing in synchronisation with the light			
SIR6030121*	12VAC/DC	420mA	25Cd(p)
SIR6030241*	24VAC/DC	215mA	18Cd(p)
SIR6030481*	48VAC/DC	105mA	8Cd(p)
SIR6031105*	110VAC	45mA	3Cd(p)
SIR6032405*	240VAC	20mA	2Cd(p)

*Specify colour A = Amber, B = Blue, C = Clear, G = Green, R = Red, Y = Yellow

Accessories and Spare Parts

Order Code	Description
SIR3500002*	Microlamp lens (*Specify colour)

Specifications:

Flash rate:	LED – 140fpm ±10 Incandescent bulb -110fpm ±20
Protection:	IP54 IP30 with audible signal
Sound output:	72dB @ 1m
Tone:	2700Hz
Duty:	Continuous
Temp rating (°C):	-30 to +50
Cable entry:	M16 - side entry
Construction:	Polycarbonate base and lens

Microlamp

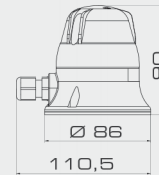
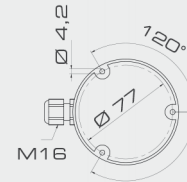

Microlamp A

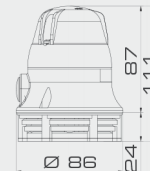

Dimensions in mm

CTL series

- High output LED
- 3 sizes
- Steady or flashing light
- Audible signal option with continuous or intermittent sound
- Multi-voltage
- Double insulated
- IP54 (IP30 with audible option)

Specifications:

Flash rate:	140fpm ±10
Sound output:	72dB @ 1m
Tone:	2700Hz
Protection:	IP54
Duty:	IP30 with audible signal
Temp rating (°C):	Continuous -30 to +50
Cable entry:	Bottom entry terminals
Construction:	Polycarbonate base and lens



CTL600



CTL900



CTL1200

Order Code	Voltage	Current	Weight (kg)
CTL600 LED continuous or triple flash – selectable by terminals			
SIR16L0240*	12-24VAC/DC ±10%	170mA	0.11
SIR16L2400*	90-240VAC ±10%	30mA	
CTL900 LED continuous or triple flash – selectable by terminals			
SIR17L0240*	12-24VAC/DC ±10%	320mA	0.19
SIR17L2400*	90-240VAC ±10%	75mA	
CTL1200 LED continuous or triple flash – selectable by terminals			
SIR18L0240*	12-24VAC/DC ±10%	320mA	0.32
SIR18L2400*	90-240VAC ±10%	75mA	
CTL900 A LED with audible signal continuous or pulsing in synchronisation with the light			
SIR606L024*	12-24VAC/DC ±10%	320mA	0.16
SIR606L240*	90-240VAC ±10%	75mA	

*Specify colour A = Amber, B = Blue, C = Clear, G = Green, R = Red, Y = Yellow

CTL 600

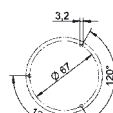
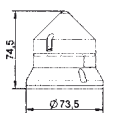

kg 0,08

CTL 900
CTL A 900

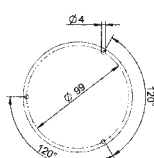
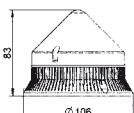

kg 0,16

CTL 1200

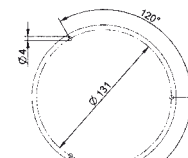
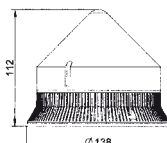

kg 0,24

Dimensions in mm

Accessories and Spare Parts

Order Code	Description
SIR3160001*	CTL600 lens (*Specify colour)
SIR3170001*	CTL900 lens (*Specify colour)
SIR3180001*	CTL1200 lens (*Specify colour)

Ovolux SMD

- High output LED
- 4 functions - steady, single, double or triple flashing light
- Surface mount with cable entry or version to suit mounting accessories
- Multi-voltage
- Double insulated
- IP65



Order Code	Voltage	Current	Weight (kg)
Ovolux R LED (for use with mounting accessories) 4 functions – selectable by DIP switches			
SIR01L0240*	12-24VAC/DC ±10%	180mA	0.15
SIR01L2400*	90-240VAC ±10%	30mA	
Ovolux M16 LED 4 functions – selectable by DIP switches			
SIR01L0241*	12-24VAC/DC ±10%	180mA	0.24
SIR01L2401*	90-240VAC ±10%	40mA	

*Specify colour A = Amber, B = Blue, C = Clear, G = Green, R = Red, Y = Yellow

Accessories and Spare Parts

Order Code	Description
SIR00L0090	AFF female-female adapter Basic adapter to mount all accessories
SIR00L0091	BS foot
SIR00L0092	PR extension stem (stackable)
SIR00L0093	BP1 single wall support
SIR00L0094	BP2 double wall support
SIR00L0096	PG9 mounting box with PG9 cable entry
SIR3001001*	Ovolux lens (*Specify colour)

OVO Mounting Systems

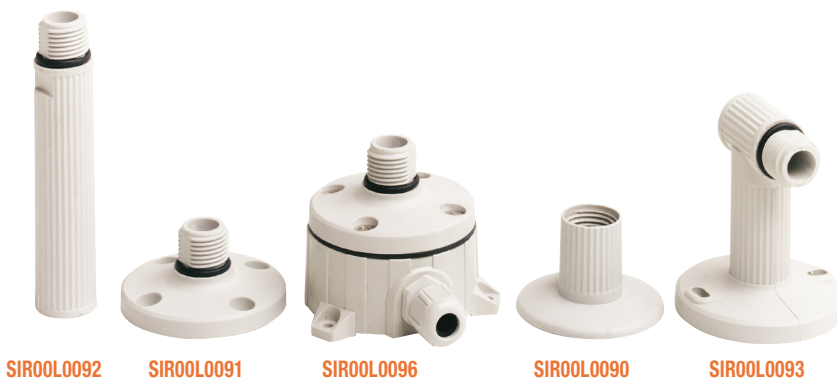

SIR00L0092 SIR00L0091 SIR00L0096 SIR00L0090 SIR00L0093

Specifications:

Flash rate:	1 x 120fpm ±10 2 x 90fpm ±10 3 x 140fpm ±10
Protection:	IP65
Duty:	Continuous
Temp rating (°C):	-30 to +50
Cable entry:	M16 side entry or through base
Construction:	Polycarbonate base and lens

Ovolux R

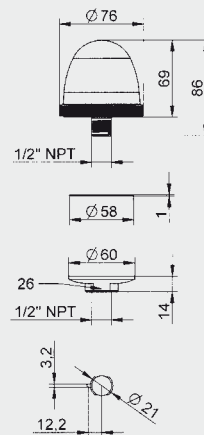

Ovolux M16

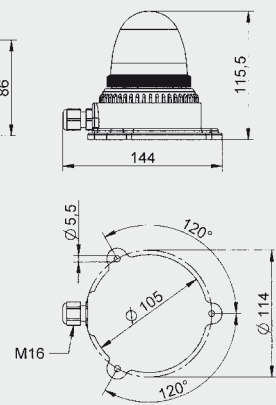

SIR00L0090

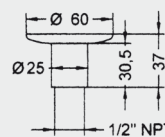

SIR00L0093

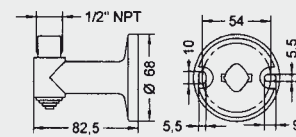

SIR00L0091

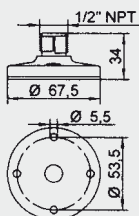

SIR00L0094

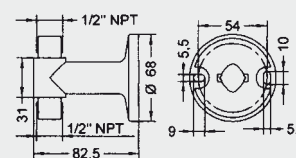

SIR00L0092

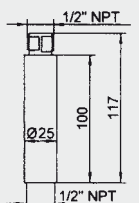

SIR00L0096

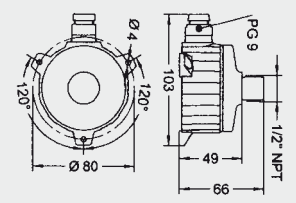

Dimensions in mm

Miniflash

- Incandescent bulb or LED
- Steady or flashing light (LED only)
- Multi-voltage (incandescent only)
- 3 mounting options
- Double insulated
- IP54



Miniflash S



Miniflash P



Miniflash E

Specifications:

Flash rate:	Incandescent – 110fpm ±20 LED – 150fpm ±20
Protection:	IP54
Duty:	Continuous
Temp rating (°C):	-30 to +50
Cable entry:	M16 or through mounting base
Construction:	Polycarbonate base and lens

Order Code	Description	Voltage	Current	Weight (kg)
Miniflash LED continuous or flashing – selectable by terminals (E27 version is flashing only)				
SIR03L0240*	Surface	24VAC/DC	180mA	0.45
SIR03L0480*		48VAC/DC	180mA	
SIR03L1100*		110VAC	40mA	
SIR03L2400*		240VAC	40mA	
SIR03L0241*	Single bolt	24VAC/DC	180mA	0.40
SIR03L0481*		48VAC/DC	180mA	
SIR03L1101*		110VAC	40mA	
SIR03L2401*		240VAC	40mA	
SIR03L0242*	E27	24VAC/DC	180mA	0.35
SIR03L0482*		48VAC/DC	180mA	
SIR03L1102*		110VAC	40mA	
SIR03L2402*		240VAC	40mA	

Miniflash L MT (bulb must be ordered separately) flashing only

Order Code	Description	Voltage	Current	Weight (kg)
SIR1304840*	Surface	12-24VDC	2.2-0.52A	0.40
SIR1324040*		24-240VAC	1.1-0.1A	
SIR1304841*	Single bolt	12-24VDC	2.2-0.52A	0.35
SIR1324041*		24-240VAC	1.1-0.1A	
SIR1304842*	E27	12-24VDC	2.2-0.52A	0.30
SIR1324042*		24-240VAC	1.1-0.1A	

*Specify colour A = Amber, B = Blue, C = Clear, G = Green, R = Red

Order Code	Voltage	Luminous Intensity
Bulbs – BA15D 25W Bulb MUST be ordered separately to suit operating voltage		
SIR3926012	12V	150Cd(p)
SIR3926024	24V	200Cd(p)
SIR3926048	48V	270Cd(p)
SIR3926110	110V	30Cd(p)
SIR3926240	240V	45Cd(p)

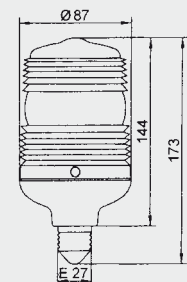
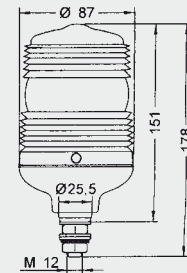
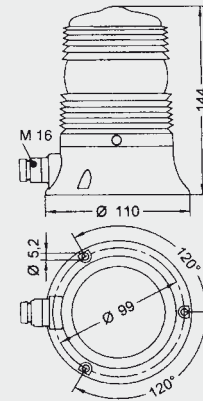

Dimensions in mm

Accessories and Spare Parts

Order Code	Description
SIR3300001*	Miniflash lens (*Specify colour)

Rotallarm S

- Multi-function high output LED
- Steady or flashing light (LED only)
- Two voltage ranges
- Double insulated
- IP65
- HD heavy duty version with aluminium base



Rotallarm S

Rotallarm HD

Order Code	Voltage	Current	Weight (kg)
Rotallarm S LED Steady, Flashing or Rotating			
SIR05L0240*	12/24V AC/DC ±10%	180mA	0.5
SIR05L2400*	90-240VAC ±10%	40mA	
Rotallarm HD LED Steady, Flashing or Rotating			
SIR05L0241*	12/24V AC/DC ±10%	180mA	0.85
SIR05L2401*	90-240VAC ±10%	40mA	

*Specify colour A = Amber, B = Blue, C = Clear, G = Green, R = Red, Y = Yellow

Specifications:

Light source:	32 x high output LED's
Flash rate:	Flashing - 85 fpm Rotating - 140 rpm
Protection:	IP65
Duty:	Continuous
Temp rating (°C):	-30 to +50
Cable entry:	M20
Construction:	Polycarbonate base and lens HD version with aluminium base

Rotallarm S

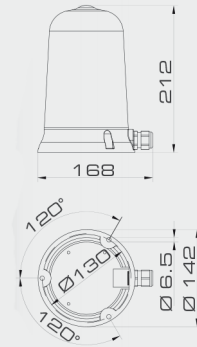

Rotallarm S with Grid and P Base

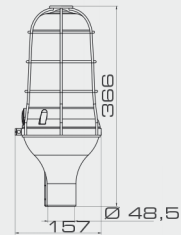

Rotallarm S with P Base

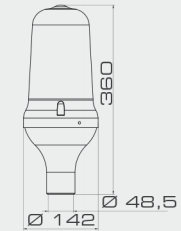

Dimensions in mm

Accessories and Spare Parts

Order Code	Description
SIR3811004	BAP Single Bolt Mount
SIR3811005	BP Wall Mount
SIR3811006	AG Tube Mount
SIR3812009	Wire Guard for Rotallarm HD
SIR3823011	Wire Guard for AG tube Mount
SIR3200001*	Rotallarm S lens (*Specify colour)

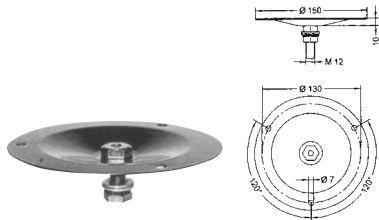

SIR3811004

Dimensions in mm

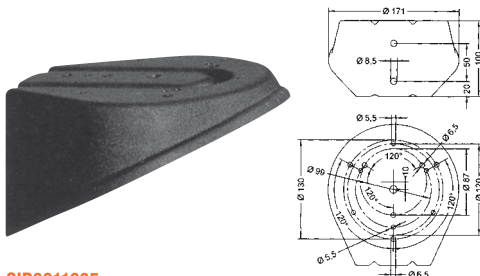

SIR3811005

Dimensions in mm

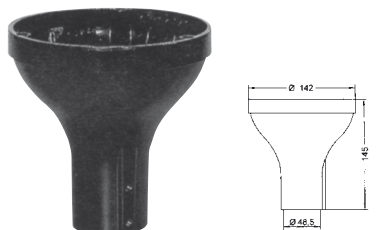

SIR3811006

Dimensions in mm



SIR3823011

B200LDA



- LED static beacon
- Multi-voltage
- IP65

Specifications:

Light intensity: 5.5cd
 Protection: IP65
 Duty: Continuous
 Temp rating (°C): -25 to +50
 Cable entry: through base 8mm grommet
 Construction: Polycarbonate base and lens
 Weight: 78g

Order Code	Voltage	Current
ESSB200LDA030B*	10-30VDC	80mA
ESSB200LDA230B*	90-240VAC	32mA

*Specify colour A = Amber, B = Blue, C = Clear, G = Green, R = Red, Y = Yellow

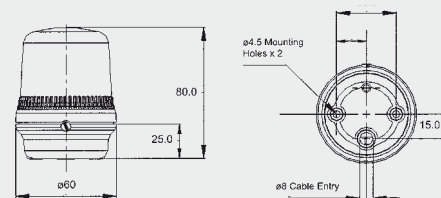

Dimensions in mm

B300LDA



- LED multifunction beacon
- 9 flash patterns
- 2 stage alarm, remotely selectable (10-50VDC version only)
- Multi-voltage
- IP65

Specifications:

Light intensity: 19cd
 Protection: IP65
 Duty: Continuous
 Temp rating (°C): -25 to +50
 Cable entry: M20 side entry
 Construction: Polycarbonate base and lens
 Weight: 370g

Flash Patterns	
Stage 1	Stage 2 (10-50VDC only)
Static	Alternate side flash 2Hz
Rotating Slow 1	Alternate side flash 2Hz
Single Flash 2Hz	Rotating Fast 2
Rotating Fast 1	Single Flash 2Hz
Rotating Slow 2	Double Flash 1Hz
Double Flash 1Hz	Rotating Fast 2
Rotating Fast 2	Double Flash 2Hz
Double Flash 2Hz	Alternate side flash 2Hz
Alternate side flash 2Hz	Rotating Fast 2

Order Code	Voltage	Current
ESSB300LDA050B*	10-50VDC	130mA (24VDC)
ESSB300LDA230B*	90-240VAC	90 - 50mA

*Specify colour A = Amber, B = Blue, C = Clear, G = Green, R = Red, Y = Yellow

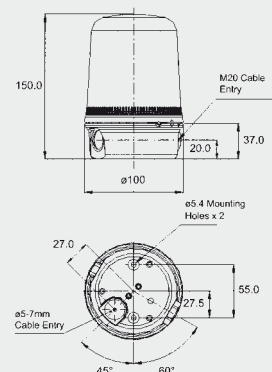

Dimensions in mm

Accessories and Spare Parts

B200 wall mount



B300 wall mount



Order Code	Description
ESSB200RAB001	B200 wall mount bracket
ESSB200TMA001	B200 tube mount (140mm high)
ESSB300RAB001	B300 wall mount bracket
ESSB300TMA001	B300 tube mount (137mm high)
ESS9B200S*	B200 lens (*Specify colour)
ESS9B300S*	B300 lens (*Specify colour)

B200 tube mount



B300 tube mount



B400 series



- LED multifunction or incandescent static beacon
- 9 flash patterns (LED version)
- 3 stage alarm, remotely selectable (10-50VDC version only)
- Multi-voltage
- IP65

Specifications:

Light intensity:	LED – 30cd Incandescent – 43cd
Protection:	IP65
Duty:	Continuous
Temp rating (°C):	-25 to +50
Cable entry:	2 x M20 side entry
Construction:	Polycarbonate base and lens

Flash Patterns		
Stage 1	Stage 2 (10-50VDC only)	Stage 3 (10-50VDC only)
Static	Alternate side flash 2Hz	Static
Rotating Slow 1	Alternate side flash 2Hz	Static
Single Flash 2Hz	Rotating Fast 2	Static
Rotating Fast 1	Single Flash 2Hz	Static
Rotating Slow 2	Double Flash 1 Hz	Static
Double Flash 1 Hz	Rotating Fast 2	Static
Rotating Fast 2	Double Flash 2Hz	Static
Double Flash 2Hz	Alternate side flash 2Hz	Static
Alternate side flash 2Hz	Rotating Fast 2	Static

Order Code	Voltage	Current	Weight
B400LDA multifunction LED			
ESSB400LDA050B*	10-50VDC	400mA (24VDC)	0.6kg
ESSB400LDA115B*	115VAC	140mA	0.85kg
ESSB400LDA230B*	230VAC	700mA	

B400SLH static beacon (bulb must be ordered separately)			
ESSB400SLH230B*	12-240VAC/DC	3.1 – 0.178A	0.54kg

*Specify colour A = Amber, B = Blue, C = Clear, G = Green, R = Red, Y = Yellow

Order Code	Voltage	Watts
Bulbs – G6.35/GY6.35 halogen		
Bulb MUST be ordered separately to suit operating voltage		
ESS9B1035012	12V	35W
ESS9B1035024	24V	35W
ESS9B1040115	115V	40W
ESS9B1040230	230V	40W

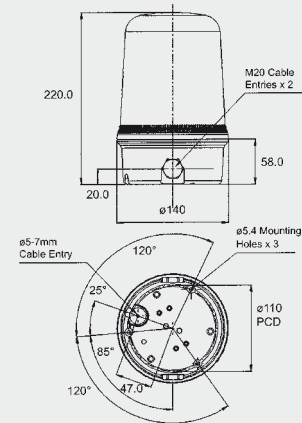

Dimensions in mm

Accessories and Spare Parts

Order Code	Description
ESSB400RAB001	B400 wall mount bracket
ESSB400TMA001	B400 tube mount (137mm high)
ESS9B400S*	B400 lens (*Specify colour)



B400 tube mount

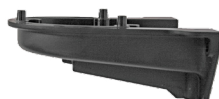

B400 wall mount

STR



- Large industrial LED beacon
- Steady or flashing light
- Heavy duty aluminum base
- Optional wire guard
- IP65

Specifications:

Light Source:	86 x 5mm LED's
Flash rate:	150fpm ± 20
Protection:	IP65
Duty:	Continuous
Temp rating (°C):	-30 to +50
Cable entry:	Through mounting base
Construction:	Polycarbonate lens, aluminum base

Order Code	Mounting	Voltage	Current	Weight (kg)
STR LED continuous or flashing – selectable by terminals				
SIR09L2024*	Surface	24VAC/DC	450mA	1.5
SIR09L2048*		48VAC/DC	180mA	
SIR09L2110*		110VAC	60mA	
SIR09L2240*		240VAC	60mA	

*Specify colour A = Amber, B = Blue, C = Clear, G = Green, R = Red, Y = Yellow

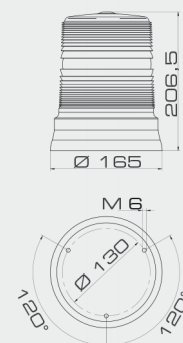

Dimensions in mm

Accessories and Spare Parts

Order Code	Description
SIR3823010	STR wire guard
SIR3600001*	STR lens (*Specify colour)



SIR3823010

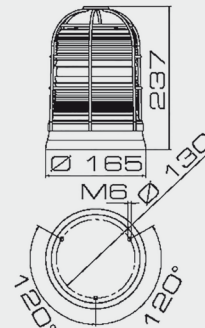

TK86HP

- 3J xenon beacon for fire, security and commercial applications
- High light output



Specifications:

Flash Rate: 90 fpm
 Protection: IP55
 Cable Entry: Through base with flying leads
 Construction: ABS Base, Acrylic Lens
 Weight: 0.23Kg

Order Code	Voltage ¹	Current	Flash Energy
MXTK86HP012*	12VDC ±10%	800mA	3.15J
MXTK86HP024*	24VDC ±10%	400mA	3.15J
MXTK86HP240*	240VAC ±10%	80mA	2.2J

*Specify colour A = Amber, B = Blue, C = Clear, G = Green, R = Red

¹ Note DC units must be supplied from power supply with less than 10% ripple

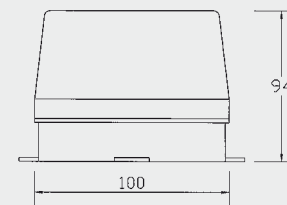
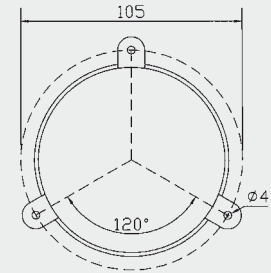

Dimensions in mm

Accessories and Spare Parts

Order Code	Description
MX90025*	TK86HP lens (*Specify colour)

NLXS

- Low power xenon beacon for fire, security and commercial applications
- Low current draw



Specifications:

Flash Rate: 100 fpm
 Protection: IP55
 Cable Entry: Through base with flying leads
 Construction: PC Base, Acrylic Lens

Order Code	Voltage ¹	Current	Weight (kg)
MXNLXS012*	12VDC ± 10%	220mA	0.075
MXNLXS024*	24VDC ± 10%	100mA	
MXNLXS024A*	24VAC ± 10%	250mA	
MXNLXS240*	240VAC ± 5%	25mA	

*Specify colour A = Amber, B = Blue, C = Clear, G = Green, R = Red

¹ Note DC units must be supplied from power supply with less than 10% ripple

Mounting is on a panel with rear access and max. thickness of 8mm

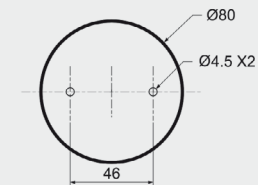
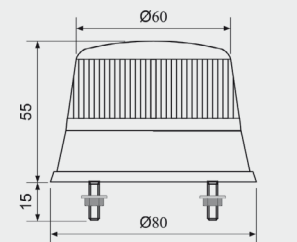

Fixed hole for screw

Dimensions in mm



L101 series



- 5J Xenon strobe or high intensity LED beacon
- Can be stacked to provide multi-signal status lights
- Synchronised 1Hz flash with adjacent beacons connected to the same supply
- Red housing with optional grey or white
- IP66
- UL approved version available



Specifications:

Light intensity:	Xenon – 200cd(e) LED – 120cd(e)
Protection:	IP66
Duty:	Continuous
Temp rating (°C):	-25 to +55
Cable entry:	M20 knockouts
Construction:	ABS Base, polycarbonate lens
Weight:	0.20kg

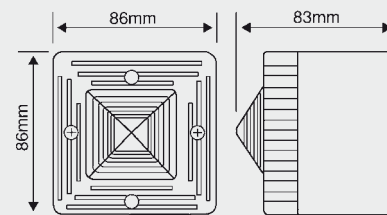

Order Code	Voltage	Current
L101 5J xenon strobe beacon 60fpm (also 90fpm and double strike flash on DC powered versions)		
ESS7005*	10-14VDC	500-380mA
ESS7010*	20-28AC/DC	250-300mA
ESS7015*	42-54VDC	175-250mA
ESS7020*	115VAC±10%	70mA
ESS7030*	230VAC±10%	35mA
L101H LED static or flashing beacon 120fpm		
ESS7010H*	10-30VDC	155mA (24VDC)
ESS7030H*	90-260AC/DC	35mA (230VAC)

*Specify colour A = Amber, B = Blue, C = Clear, G = Green, R = Red, Y = Yellow

B200STR



- 1J Xenon strobe
- Anti tamper locking screw on dome
- IP65

Specifications:

Light intensity:	37cd(e)
Flash rate:	45fpm
Protection:	IP65
Duty:	Continuous
Temp rating (°C):	-25 to +50
Cable entry:	Through base
Construction:	Polycarbonate base and lens
Weight:	78g

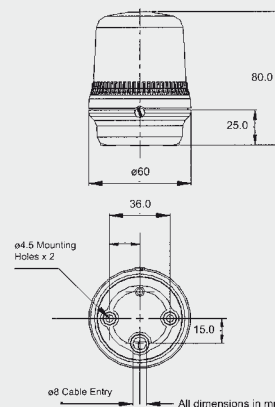

Order Code	Voltage	Current
ESSB200STR030B*	10-30VAC/DC	82mA (24VDC) 145mA (24VAC)
ESSB200STR115B*	115VAC	30mA
ESSB200STR230B*	230VAC	20mA

*Specify colour A = Amber, B = Blue, C = Clear, G = Green, R = Red, Y = Yellow

Accessories and Spare Parts

Order Code	Description
ESSB200RAB001	B200 wall mount bracket
ESSB200TMA001	B200 tube mount (140mm high)
ESS9001*	L101 lens (*Specify colour)
ESS9B200S*	B200 lens (*Specify colour)

B200 tube mount



B200 wall mount



B300ST



- 5J Xenon strobe
- Synchronised 1Hz flash with adjacent beacons connected to the same supply
- IP65

Specifications:

Light intensity: 125cd(e)
Flash energy: 5J
Flash rate: 60fpm (also 90fpm and double strike flash on DC powered versions)
Protection: IP65
Duty: Continuous
Temp rating (°C): -25 to +50
Cable entry: M20
Construction: ABS Base, polycarbonate lens
Weight: 0.37kg

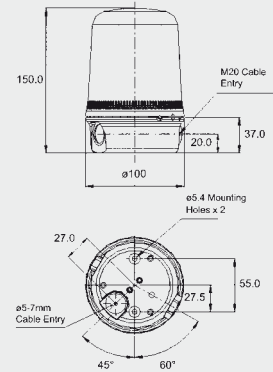

Order Code	Voltage	Current
B300STR		
ESSB300STR012B*	12VAC/DC	600-500mA
ESSB300STR024B*	24VAC/DC	300-250mA
ESSB300STR048B*	48VAC/DC	250-175mA
ESSB300STR115B*	115VAC	70mA
ESSB300STR230B*	230VAC	35mA

*Specify colour A = Amber, B = Blue, C = Clear, G = Green, R = Red, Y = Yellow

B400ST



- 15J xenon strobe
- 3 flash patterns selectable on board
- Synchronised 1Hz flash with adjacent beacons connected to the same supply
- IP65

Specifications:

Light intensity: 500cd(e)
Flash energy: 15J
Flash rate:

- 1) double flash 45fpm
- 2) single flash 60fpm (synchronised)
- 3) triple flash 30fpm

Protection: IP65
Duty: Continuous
Temp rating (°C): -25 to +50
Cable entry: M20
Construction: ABS Base, polycarbonate lens
Weight: 0.54kg

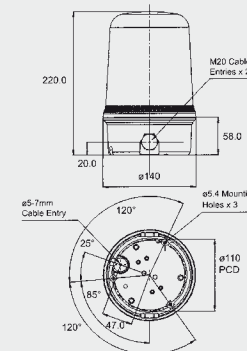

Order Code	Voltage	Current
B400STR		
ESSB400STR024B*	24VAC/DC	870mA
ESSB400STR048B*	48VAC/DC	480mA
ESSB400STR115B*	115VAC	400mA
ESSB400STR230B*	230VAC	225mA

*Specify colour A = Amber, B = Blue, C = Clear, G = Green, R = Red, Y = Yellow

Accessories and Spare Parts

B300 wall mount



B400 wall mount



Order Code	Description
ESSB300RAB001	B300 wall mount bracket
ESSB300TMA001	B300 tube mount (137mm high)
ESSB400RAB001	B400 wall mount bracket
ESSB400TMA001	B400 tube mount (137mm high)
ESS9B300S*	B300 lens (*Specify colour)
ESS9B400S*	B400 lens (*Specify colour)

B300 tube mount



B400 tube mount



LP-LT series

- 2W and 5W xenon strobe beacons
- Low and high profile design
- Multi-voltage options
- IP67 (dependent on installation method)



Order Code	Model	Voltage	Current	Flash rate
LP1 xenon strobe beacon 2W (LP4xMV/5 – 5W) low profile				
DLP401002*	LP1XMV/2	10 -100VDC 20 - 72VAC	130-37mA	75 fpm
DLP401005*	LP1XMV/5	10 -100VDC 20 - 72VAC	250-60mA	75 fpm
DLP111002*	LP1X110/2	110VAC (90-125V)	30mA	60 fpm
DLP124002*	LP1X230/2	240VAC (207-253V)	15mA	60 fpm
LT3 xenon strobe beacon 5W high profile				
DLT401005*	LT4XMV/5	10 -100VDC 20 - 72VAC	255-70mA	75 fpm
DLT311005*	LT3X110/5	110VAC (90-125V)	50mA	90 fpm
DLT324005*	LT3X230/5	240VAC (207-264V)	40mA	90 fpm

*Specify colour A = Amber, B = Blue, C = Clear, G = Green, R = Red

Note: mounting bases are required unless mounting on a panel with rear access and max. thicknesses of 8mm.

Specifications:

Protection:	IP67 (dependent on installation method)
Duty:	Continuous
Temp rating (°C):	-25 to +50
Cable entry:	M20
Construction:	Polycarbonate base and lens

LP series

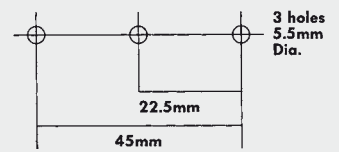
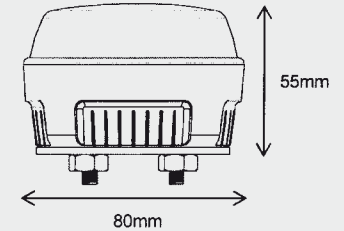

Drilling for panel mounting
2 x M5 x 15mm studs

LT series

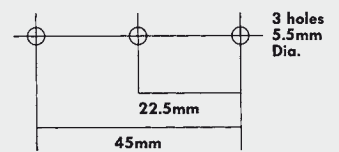
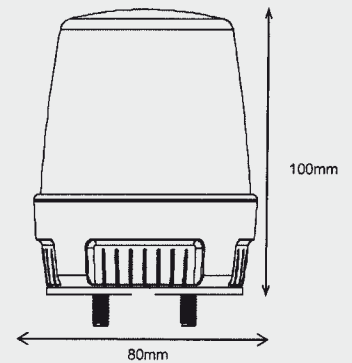

Drilling for panel mounting
2 x M5 x 15mm studs

Accessories and Spare Parts

Order Code	Description
DLFX2	FX2 surface mounting base
DLFX40	FX40 wall mounting bracket

FX2



FX40



RB series



- Xenon strobe beacons up to 15W
- Multi-voltage options
- Wide choice of mounting accessories
- IP65

Specifications:

Protection:	IP65
Duty:	Continuous
Temp rating (°C):	-20 to +55
Mounting:	Surface mounting
Cable entry:	Through base
Construction:	Polycarbonate lens, ABS base
Weight:	0.4kg
Mounting:	Vertical dome on top

Order Code	Model	Voltage	Current	Power	Candela	Flash rate
DLR201215*	RB2XDV/15	10-33VDC	1.5-0.75A	15W	60Cd	125fpm
DLR401206*	RB4XDV/6	10-32VDC	600-300mA	6W	50Cd	75fpm
DLR401002*	RB4XMV/2P	10-100VDC 20-60VAC	145-40mA	2W	18Cd	75fpm
DLR401005*	RB4XMV/5	10-100VDC 30-60VAC	360-60mA	5W	44Cd	75fpm
DLR211010*	RB2X110/10	110VAC	90mA	10W	25Cd	130fpm
DLR324010*	RB3X240/10	240VAC (207-253V)	42mA	10W	30Cd	90 fpm

*Specify colour A = Amber, B = Blue, C = Clear, R = Red

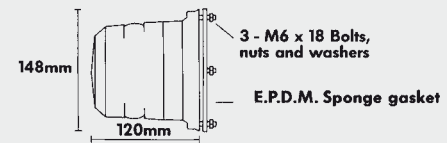
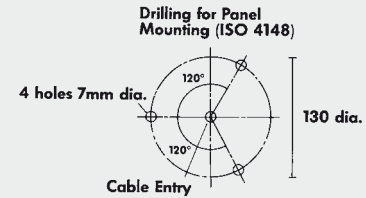

EL series



- Xenon strobe beacons up to 15W
- Double flash on 12/24V model
- Multi-voltage options
- Wide choice of mounting accessories
- IP65

Specifications:

Power output:	15W
Luminous Intensity:	100 Cd(e)
Flash rate:	120fpm
Protection:	IP65
Duty:	Continuous
Temp rating (°C):	-20 to +55
Mounting:	Surface mounting
Cable entry:	Through base
Construction:	Polycarbonate lens, ABS base
Weight:	0.45kg
Mounting:	Vertical only

Order Code	Model	Voltage	Current
DLE201215*	ELB2DXDV/15	10-33VDC	1.25-0.6A
DLE224015*	EL2SX240/15	240VAC (207-253V)	140mA

*Specify colour A = Amber, B = Blue, C = Clear, G = Green, R = Red

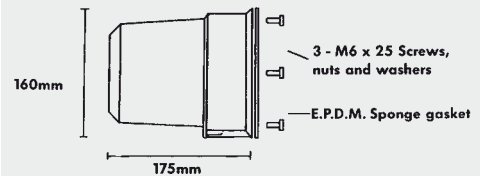

Accessories and Spare Parts

Order Code	Description
DLFX7	FX7 single bolt mount RB series
DLFX9	FX9 steel guard for RB series
DLFX10	FX10 steel guard for EL series
DLFX12	FX12 single bolt mount EL series
DLFX14	FX14 wall mount bracket RB - EL series
DLFX17	FX17 mounting clip kit EL series
DLFX28	FX28 cable entry plinth RB - EL series
DL900030*	RB lens (*Specify colour)
DL900040*	EL lens (*Specify colour)
DL900050	RB2XDV/15 xenon tube kit
DL900051	RB4XMV/5 xenon tube kit
DL900060	ELB2DXDV/15 xenon tube kit

Note: steel guards cannot be used in combination with other mounting accessories.

FX9



FX14



FX28



FX10



FX7

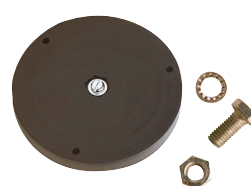

FX12



FX17



Xenoflash

- 2J xenon strobe
- 3 mounting options
- Double insulated
- IP54



Specifications:

Flash rate: 65fpm \pm 10
 Flash energy: 2J
 Protection: IP54
 Duty: Continuous
 Temp rating (°C): -30 to +40
 Cable entry: M16 or through mounting base
 Construction: Polycarbonate base and lens

Xenoflash S

Xenoflash P

Xenoflash E

Order Code	Mounting	Voltage	Current	Candela	Weight (kg)
SIR2102430*	Surface	12-24VAC/DC	400-350mA	700-1000(p)	0.30
SIR2111030*		110VAC	65mA	1300(p)	
SIR2124030*		240VAC	40mA	1450(p)	
SIR2102431*	Single bolt	12-24VAC/DC	400-350mA	700-1000(p)	0.31
SIR2111031*		110VAC	65mA	1300(p)	
SIR2124031*		240VAC	40mA	1450(p)	
SIR2102432*	E27	12-24VAC/DC	400-350mA	700-1000(p)	0.26
SIR2111032*		110VAC	65mA	1300(p)	
SIR2124032*		240VAC	40mA	1450(p)	

*Specify colour A = Amber, B = Blue, C = Clear, G = Green, R = Red

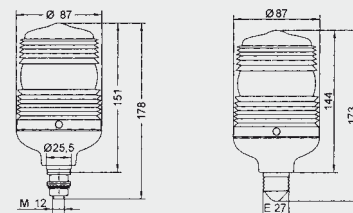
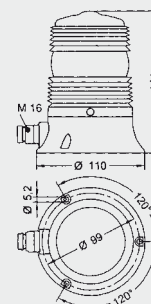

Dimensions in mm

CTLX1200

- 6J xenon strobe
- Low profile
- High output
- Double insulated
- IP54



Specifications:

Flash rate: 65fpm \pm 10
 Flash energy: 6J
 Protection: IP54
 Duty: Continuous
 Temp rating (°C): -10 to +40
 Cable entry: Through mounting base
 Construction: Polycarbonate base and lens

Order Code	Voltage	Current	Candela	Weight (kg)
SIR2002440*	12-24VAC/DC	1-0.75A	3150-3450(p)	0.30
SIR2011040*	110VAC	100mA	2700(p)	
SIR2024040*	240VAC	90mA	3500(p)	

*Specify colour A = Amber, B = Blue, C = Clear, G = Green, R = Red

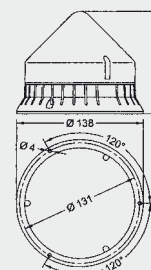

Dimensions in mm

Accessories and Spare Parts

Order Code	Description
SIR3300001*	Xenoflash lens (*Specify colour)
SIR3180001*	CTLX1200 lens (*Specify colour)
SIR3999020	2 Joule xenon tube to suit xenoflash
SIR3999060	6 Joule xenon tube to suit CTLX1200

Maxi-Xenoflash

- 6J xenon strobe
- Double insulated
- IP54



Specifications:

Flash rate:	65fpm ±10
Flash energy:	6J
Protection:	IP54
Duty:	Continuous
Temp rating (°C):	-30 to +40
Cable entry:	M16
Construction:	Polycarbonate base and lens

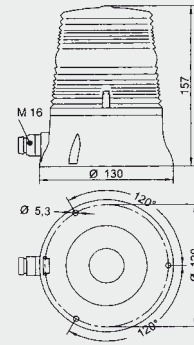

Dimensions in mm

Order Code	Voltage	Current	Candela	Weight (kg)
6J xenon tube				
SIR2202440*	12-24VAC/DC	1-0.75A	2600(p)	0.31
SIR2211040*	110VAC	100mA	2000(p)	
SIR2224040*	240VAC	90mA	2650(p)	

*Specify colour A = Amber, B = Blue, C = Clear, G = Green, R = Red

Blindo Lampalarm Xeno

- 6J xenon strobe
- Aluminium base
- Protective cage
- IP65



Specifications:

Flash rate:	65fpm ±10
Flash energy:	6J
Protection:	IP65
Duty:	Continuous
Temp rating (°C):	-30 to +40
Cable entry:	M16
Construction:	Aluminium base, polycarbonate lens, steel guard

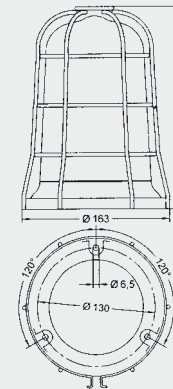

Dimensions in mm

Order Code	Voltage	Current	Candela	Weight (kg)
SIR2902440*	12-24VAC/DC	1-0.75A	3150-3500(p)	0.95
SIR2911040*	110VAC	100mA	2600(p)	
SIR2924040*	240VAC	90mA	3250(p)	

*Specify colour A = Amber, B = Blue, C = Clear, G = Green, R = Red

Accessories and Spare Parts

Order Code	Description
SIR3400001*	Maxi-xenoflash lens (*Specify colour)
SIR3200001*	Lampalarm lens (*Specify colour)
SIR3999060	6 joule xenon tube

Stroboflash

- 15J xenon strobe
- Aluminium base
- Surface or tube mounting
- IP65

Specifications:

Flash rate: 65fpm ±10
 Flash energy: 15J
 Protection: IP65
 Duty: Continuous
 Temp rating (°C): -30 to +40
 Cable entry: Through base
 Construction: Aluminium base, polycarbonate lens

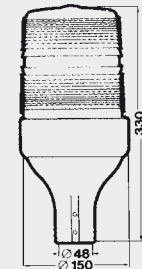
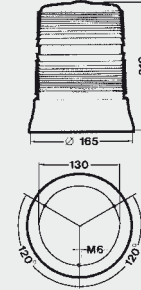

Dimensions in mm

Order Code	Mounting	Voltage	Current	Candela	Weight (kg)
SIR2302450*	Surface (N)	12-24VAC/DC	2.5-1.2A	21500(p)	1.5
SIR2311060*		110VAC	130mA	4600(p)	
SIR2324060*		240VAC	150mA	16500(p)	
SIR2302455*	Tube (AG)	12-24VAC/DC	2.5-1.2A	21500(p)	1.66
SIR2311065*		110VAC	130mA	4600(p)	
SIR2324065*		240VAC	150mA	16500(p)	

*Specify colour A = Amber, B = Blue, C = Clear, G = Green, R = Red

Accessories and Spare Parts



SIR3823010

Order Code	Description
SIR3600001*	Stroboflash lens (*Specify colour)
SIR3823010	Stroboflash N wire guard
SIR3999200	15 joule xenon tube

Model RM



- 10W rotating beacon for fire, security and commercial applications
- Low voltage lamps for longer life
- Supplied with spare lamp

Specifications:

Flash Rate: 150 rpm
 Protection: IP44
 Cable Entry: Through Base
 Construction: ABS Base, Acrylic Lens
 Mounting: Within 30° of Vertical

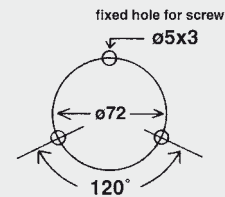
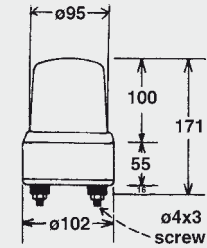

Dimensions in mm

Order Code	Voltage	Current	Bulb	Weight (kg)
MXRM012*	12VDC ±10%	850mA	12V 10W	0.6
MXRM024*	24VDC ±10%	425mA	24V 10W	
MXRM240*	240VAC ±10%	40mA	12V 8W	0.75

*Specify colour A = Amber, B = Blue, G = Green, R = Red

Model RA



- 20W rotating beacon for fire, security and commercial applications
- Low voltage lamps for longer life
- Supplied with spare lamp

Specifications:

Flash Rate: 150 rpm
 Protection: IP44
 Cable Entry: Through Base
 Construction: ABS Base, Acrylic Lens
 Mounting: Within 30° of Vertical

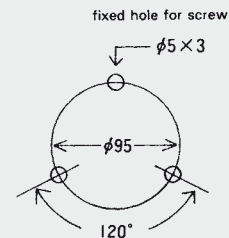
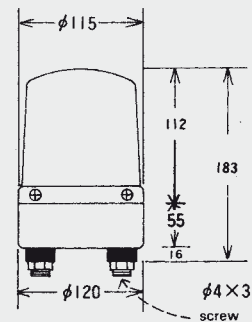

Dimensions in mm

Order Code	Voltage	Current	Bulb	Weight (kg)
MXRA012*	12VDC ±10%	1.7A	12V 20W	0.65
MXRA024*	24VDC ±10%	0.85A	24V 20W	
MXRA240*	240VAC ±10%	90mA	12V 20W	1.1

*Specify colour A = Amber, B = Blue, G = Green, R = Red

Accessories and Spare Parts

Order Code	Description
MX90120	12V 8W bulb (RM 240V)
MX90121	12V 10W bulb (RM 12V)
MX90122	24V 10W bulb (RM 24V)
MX90131	12V 20W bulb (RA 12V and 240V)
MX90132	24V 20W bulb (RA 24V)
MX90016*	RM lens (*Specify colour)
MX90014*	RA lens (*Specify colour)



EH series

- 148 or 220mm Ø base
- Low voltage bulbs
- Worm gear drive
- Metal base
- IP55



EHS



EHB

Specifications:

Flash rate:	180rpm
Protection:	IP55
Duty:	Continuous
Temp rating (°C):	-10 to +50
Cable entry:	Through base
Construction:	Painted steel base, acrylic lens
Mounting:	Surface mounting within 30° of vertical

Order Code	Voltage	Current	Bulb	Weight (kg)
EHS 148mm Ø				
MXEHS012*	12VDC	4.2A	12V 55W H1	1.25
MXEHS024*	24VDC	2.6A	24V 70W H1	
MXEHS110*	110VAC	0.3A	12V 35W Ba15S	2.0
MXEHS240*	240VAC	0.18A		
EHB 220mm Ø				
MXEHB012*	12VDC	4.2A	12V 55W H1	2.5
MXEHB024*	24VDC	2.6A	24V 70W H1	
MXEHB110*	110VAC	0.5A	12V 55W H1	3.45
MXEHB240*	240VAC	0.25A		

*Specify colour A = Amber, B = Blue, C = Clear, G = Green, R = Red

Accessories and Spare Parts

Order Code	Description
MX90010*	EHS lens (*Specify colour)
MX90012*	EHB lens (*Specify colour)
SIR3955012	12V 55W H1 bulb
SIR3970024	24V 70W H1 bulb
MX90110	12V 35W Ba15s bulb

EHS

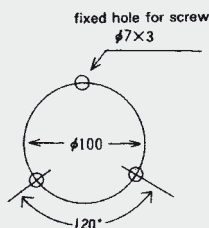
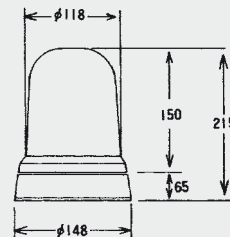

EHB

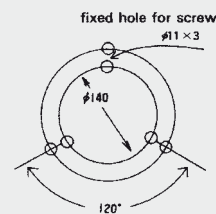
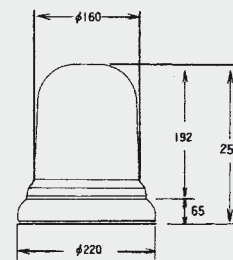

Dimensions in mm

B300RTH



- 20/25W rotating beacon
- Halogen bulbs
- Horizontal or vertical mounting (inverted)
- IP65

Specifications:

Light intensity: 125cd(e)
 Flash rate: 180rpm ±30
 Protection: IP65
 Duty: Continuous
 Temp rating (°C): -25 to +50
 Cable entry: M20
 Construction: ABS Base, polycarbonate lens
 Weight: 0.37kg

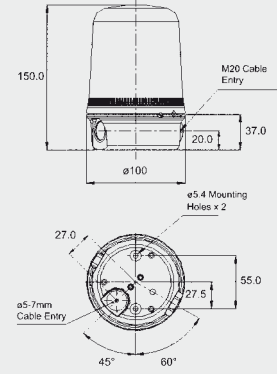

Dimensions in mm

Order Code	Voltage	Current	Bulb
ESSB300RTH012B*	12VDC	1.72A	20W G6,35
ESSB300RTH024B*	24VDC	0.91A	
ESSB300RTH115B*	115VAC	216mA	25W G6,35
ESSB300RTH230B*	230VAC	117mA	

*Specify colour A = Amber, B = Blue, C = Clear, G = Green, R = Red

B400RTH



- 35/40W rotating beacon
- Halogen bulbs
- Horizontal or vertical mounting (inverted)
- IP65

Specifications:

Light intensity: 325cd(e)
 Flash rate: 180rpm ±30
 Protection: IP65
 Duty: Continuous
 Temp rating (°C): -25 to +50
 Cable entry: 2 x M20
 Construction: ABS Base, polycarbonate lens
 Weight: 0.58kg

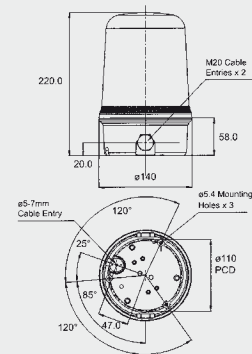

Dimensions in mm

Order Code	Voltage	Current	Bulb
ESSB400RTH012B*	12VDC	3.0A	35W G6,35
ESSB400RTH024B*	24VDC	1.54A	
ESSB400RTH115B*	115VAC	338mA	40W G6,35
ESSB400RTH230B*	230VAC	186mA	

*Specify colour A = Amber, B = Blue, C = Clear, G = Green, R = Red

Accessories and Spare Parts

Order Code	Description
ESSB300RAB001	B300 wall mount bracket
ESSB300TMA001	B300 tube mount (137mm high)
ESSB400RAB001	B400 wall mount bracket
ESSB400TMA001	B400 tube mount (137mm high)
ESS9B300R*	B300RTH lens (*Specify colour)
ESS9B400R*	B400RTH lens (*Specify colour)
ESS9B1020***	20 W G6,35 bulb (*Specify voltage 012 or 024)
ESS9B1025***	25 W G6,35 bulb (*Specify voltage 115 or 230)
ESS9B1035***	35 W G6,35 bulb (*Specify voltage 012 or 024)
ESS9B1040***	40 W G6,35 bulb (*Specify voltage 115 or 230)

B300 tube mount



B400 tube mount



B300 wall mount



B400 wall mount



Rotalarm

- Incandescent or halogen bulbs
- Heavy Duty version with aluminium base and protective cage
- Gear drive
- IP65



Specifications:

Flash rate:	160rpm +_ 30
Protection:	IP65
Duty:	Continuous
Temp rating (°C):	-30 to +50
Cable entry:	M16
Weight:	0.56kg (Blindo 1.4kg)
Construction:	Polycarbonate (aluminium) base and lens

Order Code	Voltage	Current	Bulb	Candela
Plastic base				
Aluminium base and cage				
SIR1101210*	SIR1901210*	12VDC	4A	6500(p)
SIR1101230*	SIR1901230*	12VAC		
SIR1101220*	SIR1901220*	12VDC	4.8A	10000(p)
SIR1102410*	SIR1902410*	24VDC	2.1A	6500(p)
SIR1102430*	SIR1902430*	24VAC		
SIR1102420*	SIR1902420*	24VDC	3.1A	10000(p)
SIR1102440*	SIR1902440*	24VAC		
SIR1104810*	SIR1904810*	48VDC	1.0A	6500(p)
SIR1104830*	SIR1904830*	48VAC	0.74A	600(p)
SIR1111030*	SIR1911030*	110VAC	0.31A	400(p)
SIR1124030*	SIR1924030*	240VAC	0.15A	

*Specify colour A = Amber, B = Blue, C = Clear, G = Green, R = Red

Rotalarm

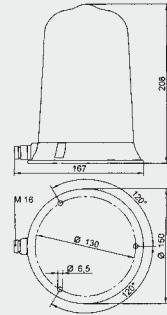

Blindo Rotalarm

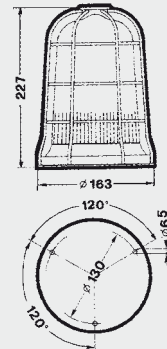

Dimensions in mm

Accessories and Spare Parts

Order Code	Description
SIR3811004	BAP Single Bolt Mount
SIR3811005	BP Wall Mount
SIR3811006	AG Tube Mount
SIR3100001*	Rotalarm lens (*Specify colour)
SIR3955012	H1 bulb 55W 12V
SIR3970012	H1 bulb 70W 24V
SIR39450**	45W BA15s bulb (*Specify voltage)
SIR3930***	25W E14T bulb (*Specify voltage)



SIR3811004



SIR3811005



SIR3811006

SIR3811004

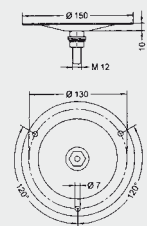

SIR3811005

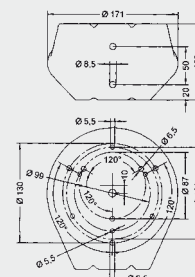

SIR3811006

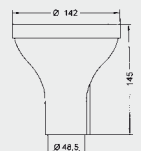

Dimensions in mm

M-Line Modular Signaling System



The M-Line modular signaling system consists of a range of LED multifunction beacons, electronic sounders and sounders with integrated LED beacon all with operating voltage of 12-24VAC/DC. The signaling units must be combined with a mounting base with or without built in power supplies to build a complete signaling device. The mounting base units and sounder units are available in a choice of four colours (Red, White, Grey or Black) and all signaling devices feature independently selectable functions via external contacts to provide different levels of alarm in a single device. All mounting base units are available with a choice of three voltage ranges (12-24VAC/DC, 30-80VAC/DC and 120-240VAC).

An economy range of sounders and sounders with integrated LED's supplied complete with a surface mount base is also available.

General characteristics:

FLR S Multi-function LED Beacon

With a choice of 3 light effects (steady, flashing or rotating) selected via external contacts. Available with choice of coloured lens or clear lens (with colour LED's). Colours available – Amber, Red, Blue and Green.

SLR S High Output Multi-function LED Beacon

With a choice of 3 light effects (flashing, strobe light or super bright random effect) selected via external contacts. Available with choice of coloured lens or clear lens (with colour LED's). Colours available – Amber, Red, Blue, Green and White.

XLF S Low Profile Multi-function LED Beacon

With a choice of 3 light effects (steady, flashing or strobe) selected via external contacts. Available with choice of coloured lens or clear lens (with colour LED's) and with either proximity lens for use close to personnel or with directional lens for longer distance signaling. Colours available – Amber, Red, Blue and Green.

XLF RGA Low Profile Multi-colour LED Beacon

With 3 colours in one beacon (Red, Amber and Green) selected via external contacts and a choice of steady or flashing light selected by DIP switches.

SIR-E S

Electronic sounder with 2 stage alarm selected by external contacts and choice of 32 tones for each stage. 105dB sound output with volume adjustment (65-105dB). Housing available in 4 colours (Red, White, Grey and Black)

SIR-E Max

High output electronic sounder with 2 stage alarm selected by external contacts and choice of 32 tones for each stage. 115dB sound output with volume adjustment (65-115dB). Housing available in 4 colours (Red, White, Grey and Black)

SIR-EJ

Electronic sounder with 2 stage alarm selected by external contacts and choice of 8 tones for each stage. Includes Australian standard alert and evacuation tones. 100dB sound output. Housing available in 2 colours (Red and White).

SIR-E LED S

Electronic sounder/beacon with 3 stage alarm selected by external contacts, with flashing light for stage 1, flashing light and sounder for stage 2 and steady light with sounder for stage 3 and choice of 32 tones for stages 2 and 3. 105dB sound output with volume adjustment (65-105dB). LED colours available - Amber, Red, Blue and Green.

SIR-E LED MAX

Electronic sounder/beacon with 3 stage alarm selected by external contacts, with flashing light for stage 1, flashing light and sounder for stage 2 and steady light with sounder for stage 3 and choice of 32 tones for stages 2 and 3. 115dB sound output with volume adjustment (65-115dB). LED colours available - Amber, Red, Blue and Green.

SIR-EJ LED

Electronic sounder/beacon with 3 stage alarm selected by external contacts, with flashing light for stage 1, flashing light and sounder for stage 2 and steady light with sounder for stage 3 and choice of 8 tones for stages 2 and 3. 100dB sound output. Includes Australian standard alert and evacuation tones. LED colours available - Amber, Red, Blue and Green.

Mounting Bases

Quick connect mounting bases surface mount (shallow and deep version with cable entries), wall mount, double wall mount, ceiling mount and pole mount. Three voltage ranges available (12-24VAC/DC, 30-80VAC/DC and 120-240VAC) Bases available in 4 colours (Red, White, Grey and Black)

Common specifications:

Duty:	Continuous
Temp rating (°C):	-30 to +50
Cable entry:	2 x M20 on deep surface mount and wall mount bases
Construction:	Polycarbonate

Compliance and standards:

Certifications obtained: CE, UL, PCT

M-Line Modular Signaling System



FLR S LED Beacon

Colour	Order Code (Beacon only)		Weight (kg)
	Coloured Lens	Clear Lens Coloured LED	
Blue	SIR01M90351	SIR01M90121	0.2
Amber	SIR01M90352	SIR01M90122	0.2
Red	SIR01M90353	SIR01M90123	0.2
Green	SIR01M90354	SIR01M90124	0.2



SLR S High Output LED Beacon

Colour	Order Code (Beacon only)		Weight (kg)
	Coloured Lens	Clear Lens Coloured LED	
Blue	SIR01M90851	SIR01M90861	0.2
Amber	SIR01M90852	SIR01M90862	0.2
Red	SIR01M90853	SIR01M90863	0.2
Green	SIR01M90854	SIR01M90864	0.2
White	SIR01M90856	-	0.2



XLF Proximity

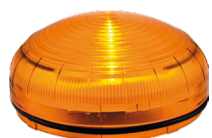

XLF Directional

XLF S Low Profile LED Beacon

Colour	Order Code (Beacon only)		Weight (kg)
	Proximity Lens	Directional Lens	
Blue	SIR01M90501	SIR01M90821	0.11
Amber	SIR01M90502	SIR01M90822	0.11
Red	SIR01M90503	SIR01M90823	0.11
Green	SIR01M90504	SIR01M90824	0.11



XLF RGA Proximity



XLF RGA Directional

XLF RGA Low Profile Multi-colour LED Beacon

Colour	Order Code (Beacon only)		Weight (kg)
	Proximity Lens	Directional Lens	
Red	SIR01M90507	SIR01M90847	0.11
Amber			
Green			

Specifications:

FLR S LED Beacon

Flash Patterns: Steady, flashing (85fprm), rotating (140rpm)
 Current: 12-24VAC/DC – 510-360mA
 30-80VAC/DC – 300-110mA
 90-240VAC – 100-70mA
 Protection: IP66

SLR S High Output LED Beacon

Flash Patterns: Flashing (150fprm), strobe (5 x 72fprm), random
 Current: 12-24VAC/DC – 450-700mA
 30-80VAC/DC – 800-250mA
 90-240VAC – 150-40mA
 Protection: IP66

FLR-SLR

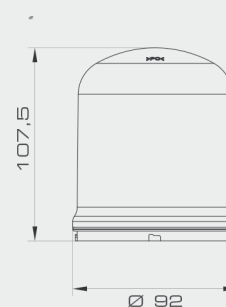

Dimensions in mm

XLF S Low Profile LED Beacon

Flash Patterns: Steady, flashing (150fprm), strobe (5 x 72fprm)
 Current: 12-24VAC/DC – 300-270mA
 30-80VAC/DC – 240-100mA
 90-240VAC – 80-50mA
 Protection: IP66

XLF RGA Low Profile Multi-colour LED Beacon

Flash Patterns: Steady, flashing (150fprm)
 Current: 12-24VAC/DC – 370-310mA
 30-80VAC/DC – 250-100mA
 90-240VAC – 90-55mA
 Protection: IP66

XLF - XLF RGA



Dimensions in mm

M-Line Modular Signaling System



SIR-E S

SIR-E S Sounder (with volume control)

Order Code	Body Colour	Weight (Kg)
SIR05M90358	Red	0.22
SIR05M90359	White	0.22
SIR05M90360	Grey	0.22
SIR05M90357	Black	0.22



SIR-E MAX

SIR-E MAX Sounder (with volume control)

Order Code	Body Colour	Weight (Kg)
SIR05M90410	Red	0.54
SIR05M90409	White	0.54
SIR05M90407	Grey	0.54
SIR05M90408	Black	0.54



SIR-EJ

SIR-EJ Sounder (without volume control)

Order Code	Body Colour	Weight (Kg)
SIR05M90389	Red	0.22
SIR05M90388	White	0.22
SIR05M90387	Grey	0.22
SIR05M90390	Black	0.22

Specifications:

SIR-E S Sounder

Maximum Sound Output: 105dB @ 1m – actual sound output depends on tone and voltage

Nominal Sound Output: 12-24V – 101.5-103dB
40-80V – 100dB
90-240V – 100dB

Tones: 2 x 32 tones in 2 channels – see tone table on page 11-27

Current: 12-24VAC/DC – 215-250 mA
30-80VAC/DC – 55-155mA
90-240VAC – 60-35mA

Protection: IP65

SIR-E S

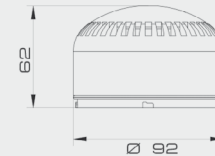

Dimensions in mm

SIR-E MAX Sounder

Maximum Sound Output: 115dB @ 1m – actual sound output depends on tone and voltage

Nominal Sound Output: 12-24V – 103-115dB
40-80V – 101-113dB
90-240V – 99-111dB

Tones: 2 x 32 tones in 2 channels – see tone table on page 11-27

Current: 12-24VAC/DC – 3-0.5A
30-80VAC/DC – 0.6-0.12A
90-240VAC – 150-50mA

Protection: IP65

SIR-E MAX



Dimensions in mm

SIR-E MAX Sounder

Maximum Sound Output: 100dB @ 1m

Tones: 2 x 8 tones in 2 channels – see tone table on page 11-27

Current: 12-24VAC/DC – 200-300mA
30-80VAC/DC – 220-90mA
90-240VAC – 75-30mA

Protection: IP65

SIR-EJ

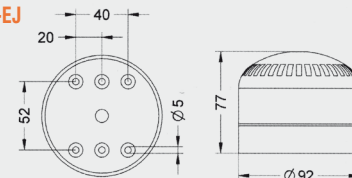

Dimensions in mm

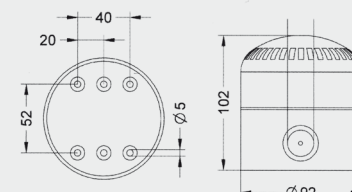

M-Line Modular Signaling System



SIR-E LED S

SIR-E LED S Sounder-Beacon (with volume control)

Order Code	LED Colour	Weight (kg)
SIR05M90361	Blue	0.22
SIR05M90362	Amber	0.22
SIR05M90363	Red	0.22
SIR05M90364	Green	0.22



SIR-E LED MAX

SIR-E LED MAX Sounder-Beacon (with volume control)

Order Code	LED Colour	Weight (kg)
SIR05M90561	Blue	0.54
SIR05M90562	Amber	0.54
SIR05M90563	Red	0.54
SIR05M90564	Green	0.54



SIR-EJ LED

SIR-EJ LED Sounder-Beacon (without volume control)

Order Code	LED Colour	Weight (kg)
SIR05M90421	Blue	0.22
SIR05M90422	Amber	0.22
SIR05M90423	Red	0.22
SIR05M90424	Green	0.22

Specifications:

SIR-E LED S Sounder-Beacon

Maximum Sound Output: 105dB @ 1m – actual sound output depends on tone and voltage
 Nominal Sound Output: 12-24V – 101.5-103dB
 40-80V – 100dB
 90-240V – 100dB
 Tones: 2 x 32 tones in 2 channels – see tone table on page 11-27
 Current: 12-24VAC/DC – 300-350mA
 30-80VAC/DC – 80-265mA
 90-240VAC – 95-60mA
 Protection: IP65

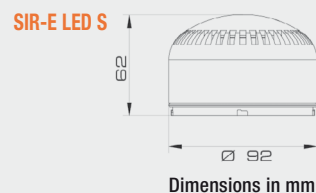

SIR-E LED MAX Sounder-Beacon

Maximum Sound Output: 115dB @ 1m – actual sound output depends on tone and voltage
 Nominal Sound Output: 12-24V – 103 - 115dB
 40-80V – 101 - 113dB
 90-240V – 99 - 111dB
 Tones: 2 x 32 tones in 2 channels – see tone table on page 11-27
 Current: 12-24VAC/DC – 3 - 0.5A
 30-80VAC/DC – 0.6 - 0.12A
 90-240VAC – 150 - 50mA
 Protection: IP65

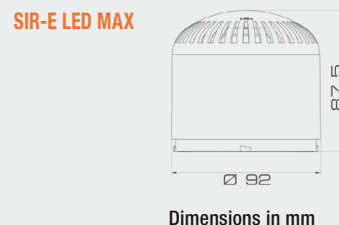

SIR-EJ LED Sounder-Beacon

Maximum Sound Output: 100dB @ 1m
 Tones: 2 x 8 tones in 2 channels – see tone table on page 11-27
 Current: 12-24VAC/DC – 250 - 340 mA
 30-80VAC/DC – 250-100mA
 120-240VAC – 80-35mA
 Protection: IP65

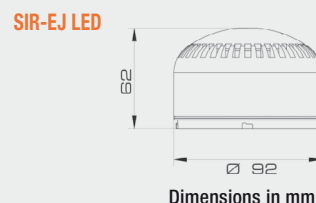

M-Line Modular Signaling System



Shallow Base



Deep Base



Wall Base



Double Base



Ceiling Base



Pole Base

Mounting Bases

Order Code	Mounting	Colour	Voltage	Weight (kg)
SIR01M90343	Surface mounting shallow base	Red	12-24VAC/DC	0.06
SIR01M90344	Surface mounting shallow base	White		
SIR01M90367	Surface mounting shallow base	Grey		
SIR01M90451	Surface mounting shallow base	Black		
SIR01M90345	Surface mounting deep base	Red	12-24VAC/DC	0.12
SIR01M90346	Surface mounting deep base	White		
SIR01M90368	Surface mounting deep base	Grey		
SIR01M90452	Surface mounting deep base	Black		
SIR01M90442	Surface mounting deep base	Red	30-80VAC/DC	0.17
SIR01M90437	Surface mounting deep base	White		
SIR01M90432	Surface mounting deep base	Grey		
SIR01M90455	Surface mounting deep base	Black		
SIR01M90508	Surface mounting deep base	Red	90-240VAC	0.17
SIR01M90509	Surface mounting deep base	White		
SIR01M90369	Surface mounting deep base	Grey		
SIR01M90458	Surface mounting deep base	Black		
SIR01M90347	Wall mounting base	Red	12-24VAC/DC	0.19
SIR01M90348	Wall mounting base	White		
SIR01M90370	Wall mounting base	Grey		
SIR01M90453	Wall mounting base	Black		
SIR01M90443	Wall mounting base	Red	30-80VAC/DC	0.24
SIR01M90438	Wall mounting base	White		
SIR01M90433	Wall mounting base	Grey		
SIR01M90456	Wall mounting base	Black		
SIR01M90510	Wall mounting base	Red	90-240VAC	0.24
SIR01M90511	Wall mounting base	White		
SIR01M90371	Wall mounting base	Grey		
SIR01M90459	Wall mounting base	Black		
SIR01M90373	Double wall mounting base	Red	12-24VAC/DC	0.26
SIR01M90374	Double wall mounting base	White		
SIR01M90372	Double wall mounting base	Grey		
SIR01M90454	Double wall mounting base	Black		
SIR01M90445	Double wall mounting base	Red	30-80VAC/DC	0.35
SIR01M90440	Double wall mounting base	White		
SIR01M90435	Double wall mounting base	Grey		
SIR01M90457	Double wall mounting base	Black		
SIR01M90513	Double wall mounting base	Red	90-240VAC	0.35
SIR01M90514	Double wall mounting base	White		
SIR01M90512	Double wall mounting base	Grey		
SIR01M90460	Double wall mounting base	Black		
SIR01M90349	Ceiling flush mounting base*	Red	12-24VAC/DC	0.22
SIR01M90375	Ceiling flush mounting base*	White	30-80VAC/DC	0.27
SIR01M90444	Ceiling flush mounting base*	Red		
SIR01M90439	Ceiling flush mounting base*	White	90-240VAC	0.27
SIR01M90446	Ceiling flush mounting base*	Red		
SIR01M90376	Ceiling flush mounting base*	White	12-24VAC/DC	0.15
SIR01M90610	Pole (1½" NPT) mounting base	Grey		
SIR01M90613	Pole (1½" NPT) mounting base	Black		
SIR01M90611	Pole (1½" NPT) mounting base	Grey		
SIR01M90614	Pole (1½" NPT) mounting base	Black	30-80VAC/DC	0.19
SIR01M90612	Pole (1½" NPT) mounting base	Grey	90-240VAC	0.19
SIR01M90615	Pole (1½" NPT) mounting base	Black		

* For indoor use only

Shallow Base

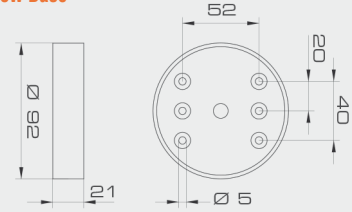

Deep Base

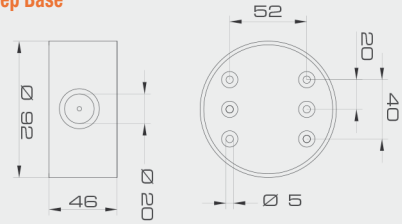

Wall Base

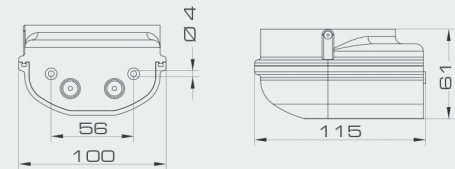

Double Base

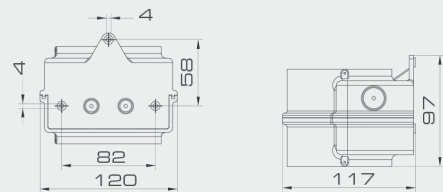

Ceiling Base

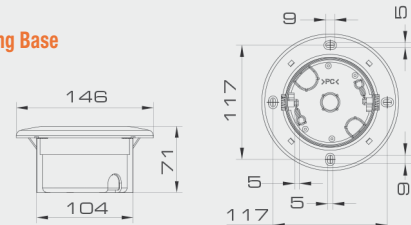

Pole Base

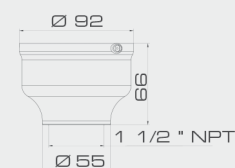

Dimensions in mm

M-Line Modular Signaling System



SIR-E Red



SIR-E LED Red

Economy Sounder and Sounder-Beacon complete with bases
SIR-EJ Sounder and SIR-EJ LED Sounder (without volume control, 2 x 8 tones)

Order Code	Description	Voltage	Current	Weight (kg)
SIR05M90391	Sounder shallow base red	12-24 VAC/DC	200-300mA	0.28
SIR05M90392	Sounder shallow base white			
SIR05M90393	Sounder deep base red	12-24 VAC/DC	200-300mA	0.34
SIR05M90394	Sounder deep base white			
SIR05M90395	Sounder deep base red	90-240 VAC	75-30mA	0.37
SIR05M90396	Sounder deep base white			
SIR05M90397	Sounder/LED shallow base red/red	12-24 VAC/DC	250-340mA	0.28
SIR05M90398	Sounder/LED deep base red/red			0.34
SIR05M90399	Sounder/LED deep base red/red	90-240 VAC	80-35mA	0.37

SIR-E

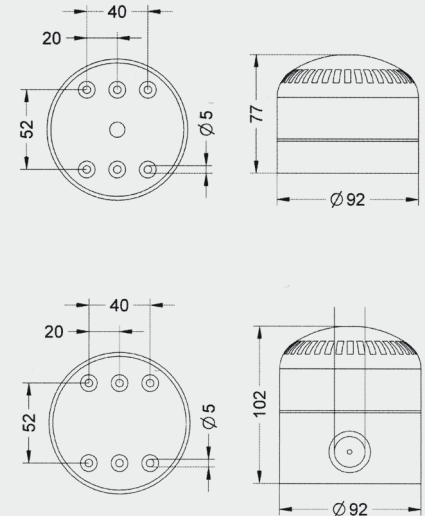

Dimensions in mm

Accessories



Order Code	Description	Suitable Models	Weight (kg)
SIR01M90557	Stainless steel guard size 0	XLF with shallow base	0.07
SIR01M90551	Stainless steel guard size 1	SIR-E, SIR-E LED with shallow base XLF with deep base	0.08
SIR01M90552	Stainless steel guard size 2	SIR-E, SIR-E LED with deep base SIR-E MAX, SIR-E LED MAX with shallow base	0.10
SIR01M90553	Stainless steel guard size 3	FLR, SLR with shallow base SIR-E MAX, SIR-E LED MAX with deep base	0.13
SIR01M90554	Stainless steel guard size 4	FLR, SLR with deep base	0.14

Size 0

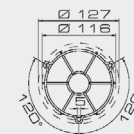

Size 1



Size 2

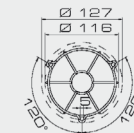

Size 3



Size 4

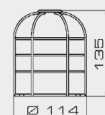

M-Line Modular Signaling System Sounder Tones



SIR-EJ and SIR-EJ LED – stage 1 and 2 tones can be selected independently

Tone	Stage 1	Stage 2
1	420Hz 0.625s ON / 0.625Hz OFF (Australia AS1670 Alert tone)	420Hz 0.625s ON / 0.625Hz OFF (Australia AS1670 Alert tone)
2	1000-2500Hz 0.5s ON / 0.5s OFF x 3/1.5s OFF (AS1670 Evacuation)	1000-2500Hz 0.5s ON / 0.5s OFF x 3/1.5s OFF (AS1670 Evacuation)
3	500-1200Hz 0.5s ON / 0.5s OFF x 3/1.5s OFF (AS1670 Evacuation)	500-1200Hz 0.5s ON / 0.5s OFF x 3/1.5s OFF (AS1670 Evacuation)
4	500-1200Hz 3.75s ON / 0.25s OFF (AS2220 Evacuation)	500-1200Hz 3.75s ON / 0.25s OFF (AS2220 Evacuation)
5	Simulated bell	Simulated bell
6	Bi-tone 800 and 970Hz, 250ms on, 250ms off	Linear 970Hz
7	Linear 2850Hz	Modulated 1000-1700Hz
8	Intermittent 970Hz 1s on, 1s off	Bi Tone 2400-2850Hz 0.465s/0.465s

SIR-E and SIR-E LED – stage 1 and 2 tones can be selected independently

1	Bi-tone 600 – 700hz 0.5s/0.5s	Warning 490Hz 0.5s on/1s off
2	Multi-tone 1000 – 1700hz cycle 0.25s	Evacuation 1 480 – 610Hz 0.5s/0.5s
3	Modulated 1000 – 1700 cycle 0.8s	Evacuation 2 610Hz
4	Evacuation 440 – 560hz 565s/565s	Linear 500Hz
5	Linear 300hz	Linear 970Hz BS5839-1
6	linear 660hz	Sweep 500 – 1200Hz cycle 3.75s/0.25s off AS2220
7	Linear 750hz	Sweep 1400 – 1600Hz cycle 1.5s NF 48-265
8	Linear 2850	Sweep 1200 – 500Hz cycle 1s DIN 33 404
9	Sweep 500 – 1200hz 3.5s on/0.5s off	Intermittent 544Hz 0.625s on/0.625s off
10	Sweep 500 – 1200Hz 0.5s on/0.5s off x 3 1.5 s off Australia AS1670	Intermittent 660Hz 6.5s on/ 13s off
11	Sweep 800-970hz 0.5s on/0.5s off x 3 1.5s off ISO 8201	Intermittent 970Hz 1s on/1s off Apollo fire system BS5839
12	Intermittent 420Hz 0.625s on/0.625s off Australia AS1670 alert tone	Intermittent 2850Hz 0.5s on/0.5s off x 3 1.5s off ISO 8201 high tone
13	Intermittent 660Hz 0.15s on/0.15s off	Bi-tone 970 – 630Hz 0.5s/0.5s Apollo fire system BS5839
14	Intermittent 660Hz 1.8s on/1.8s off	Bi-tone 554 – 440Hz 0.1s/0.4s
15	Intermittent 660Hz 0.5s on/0.5s off	Bi-tone 440 – 554Hz 0.5s/0.5s
16	Intermittent 720Hz 0.7s on/0.3s off	Bi-tone 510 – 610Hz 0.5s/0.5s
17	Intermittent 750Hz 0.33s on/0.5s off	Bi-tone 510 – 610Hz 1s/1s
18	Intermittent 800Hz 0.25s on/1s off	Bi-tone 600 – 700Hz 1s/1s
19	Intermittent 970 -800Hz 0.35s /0.35s/0.35s off x 3 1.5s off ISO 8201	Bi-tone 550 – 1000Hz 0.5s/0.5s
20	Intermittent 970Hz 0.25s on/0.25s off	Bi-tone 550 – 1000Hz 1s/1s
21	Intermittent 2850Hz 1s on/1s off	Bi-tone 800 – 1000Hz 0.5s/0.5s
22	Intermittent 2850Hz 0.25s on/0.25s off	Bi-tone 800 – 1000Hz 1s/1s
23	Bi-tone 600 – 700Hz 0.5s/0.5s	Bi-tone 1000 – 2000Hz 0.5s/0.5s
24	Bi-tone 800 – 970Hz 0.25s/0.25s BS5839-1:2002	Bi-tone 2400 – 2850Hz 0.265s/0.265s
25	Bi-tone 800 – 970Hz 0.800s/0.800s	Bi-tone 2400 – 2850Hz 0.465s/0.465s
26	Bi-tone 1000 – 2000Hz 1s/1s	Bi-tone 640 – 970Hz 0.5s/0.5s
27	Chime 1 single 700-600Hz 0.4s/0.7s single shot ding dong	Bi-tone 490 – 610Hz 0.25s/0.25s
28	Chime 1 repeating 700-600Hz 0.4s/0.7s off repeating ding dong	Chime 2 single 554-440Hz 0.35s/0.7s single shot ding dong
29	Chime 1 repeating 700-600 0.25s/0.4 off repeating ding dong	Chime 2 rep 554-440Hz 0.35s/0.7s /0.5s off repeating ding dong
30	Hooter repeating - 3s on/2s off	Chime 3 single 1300-944Hz 0.5s/1s single shot ding dong
31	Simulated bell 1850Hz	Chime 3 rep 1300-944Hz 0.5s/1s/0.5s off repeating ding dong

SONF1

- Electronic sounder up to 100dB
- 10 tones (includes ISO tones to Australian Standards)
- Automatic synchronisation on multi-sounder systems*
- Volume control
- Two stage alarm (DC voltage only) by reversing polarity
- Available in red or white
- Volume control
- IP66



Order Code	Colour	Voltage	Current
ESS0015RX	Red	10-30VDC	25mA @ 24VDC
ESS0015WX	White		
ESS0016RX	Red	24VAC ±10%	40mA
ESS0016WX	White		
ESS0017RX	Red	115VAC ±10%	13mA
ESS0017WX	White		
ESS0018RX	Red	230VAC ±10%	13mA
ESS0018WX	White		

*Synchronisation requires sounders to be connected to the same power supply

Specifications:

Sound output:	100dB @ 1m
Sound frequency:	10 tones see tone list on page 11-37
Protection:	IP66
Temp rating (°C):	-25 to +55
Cable entry:	4 x M20 knockouts
Rating:	Continuous
Construction:	Flame Retardant ABS
Weight:	0.30Kg

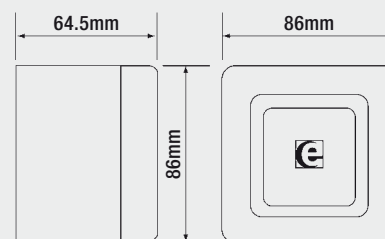

SON2

- Electronic sounder up to 104dB
- 32 tones (includes ISO tones to Australian Standards)
- Automatic synchronisation on multi-sounder systems*
- Three stage alarm
- Available in red or white
- 3 volume levels (reverse polarity stage switching on DC units)
- IP66



Order Code	Colour	Voltage	Current
ESS0020RX	Red	10-30VDC	20-80mA
ESS0020WX	White		
ESS0022RX	Red	24VAC ±10%	25-90mA
ESS0022WX	White		
ESS0024RX	Red	115VAC ±10%	24mA
ESS0024WX	White		
ESS0025RX	Red	230VAC ±10%	12mA
ESS0025WX	White		

*Synchronisation requires sounders to be connected to the same power supply

Specifications:

Sound output:	104dB @ 1m
Sound frequency:	32 tones see tone list on page 11-37
Protection:	IP66
Temp rating (°C):	-25 to +55
Cable entry:	4 x M20 knockouts
Rating:	Continuous
Construction:	Flame Retardant ABS
Weight:	0.30Kg (DC), 0.40kg (AC)

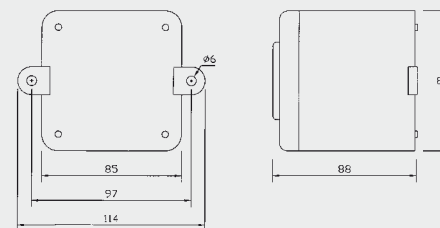

Dimensions in mm

SONFL1



- Electronic sounder with xenon or LED beacon
- 10 tones (includes ISO tones to Australian Standards)
- Automatic synchronisation on multi-sounder systems**
- Sounder and beacon controlled independently
- Volume control
- Two stage alarm (DC voltage only) by reversing polarity
- Available in red or white housing
- IP66

Specifications:

Sound output:	100dB @ 1m
Sound frequency:	10 tones see tone list on page 11-37
Flash energy:	5J (xenon version)
Light output:	Xenon 200cd(e) LED 120cd(e)
Flash rate:	Xenon 60fpm LED 120fpm or steady
Protection:	IP66
Temp rating (°C):	-25 to +55
Cable entry:	4 x M20 knockouts
Rating:	Continuous
Construction:	Flame Retardant ABS
Weight:	0.50Kg

Order Code	Housing Colour	Voltage	Current Sounder	Current Beacon
SONFL1 – with xenon beacon				
ESS0050R*	Red	12VDC	25mA	500mA
ESS0050W*	White			
ESS0051R*	Red	24VDC	25mA	250mA
ESS0051W*	White			
ESS0052R*	Red	24VAC ±10%	40mA	300mA
ESS0052W*	White			
ESS0054R*	Red	115VAC ±10%	13mA	70mA
ESS0054W*	White			
ESS0053R*	Red	230VAC ±10%	13mA	35mA
ESS0053W*	White			

*Specify colour A = Amber, B = Blue, C = Clear, G = Green, R = Red

Order Code	Housing Colour	Voltage	Current Sounder	Current Beacon
SONFL1 – with H LED beacon				
ESS0051R*LED	Red	10-30VDC	25mA @ 24VDC	115mA @ 24VDC
ESS0051W*LED	White			
ESS0054R*LED	Red	115VAC ±10%	13mA	70mA
ESS0054W*LED	White			
ESS0053R*LED	Red	230VAC ±10%	13mA	35mA
ESS0053W*LED	White			

*Specify colour A = Amber, B = Blue, G = Green, R = Red
Note lens colour on LED beacon is clear

**Synchronisation requires sounders to be connected to the same power supply

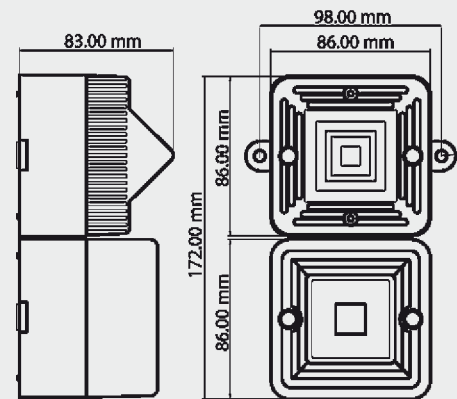

SON4

- Electronic sounder with xenon or LED beacon
- 10 tones (LED) or 32 tones (xenon), includes ISO tones to Australian Standards
- Automatic synchronisation on multi-sounder systems**
- Volume control (3 volume levels on xenon version)
- Three stage alarm (reverse polarity stage switching on DC units)
- Available in red or white housing
- IP66



Specifications:

Sound output:	SON4L 100dB @ 1m SON4 104dB @ 1m
Sound frequency:	LED 10 tones see tone list on page 11-38 Xenon 32 tones see tone list on page 11-37
Light output:	LED 3cd(e) Xenon 11cd(e)
Flash rate:	LED 120fpm Xenon 60fpm
Protection:	IP66
Temp rating (°C):	-25 to +55
Cable entry:	4 x M20 knockouts
Rating:	Continuous
Construction:	Flame Retardant ABS
Weight:	0.30kg (DC), 0.40kg (AC)

Order Code	Housing Colour	Voltage	Current
SON4 – with xenon beacon			
ESS0040R*X	Red	18-30VDC	80-110mA
ESS0040W*X	White		
ESS0042R*X	Red	115VAC ±10%	35mA
ESS0042W*X	White		
ESS0043R*X	Red	230VAC ±10%	20mA
ESS0043W*X	White		

*Specify colour A = Amber, B = Blue, G = Green, R = Red

SON4L – with H LED beacon			
ESS0045LR*	Red	24VDC ±25%	50mA
ESS0045LW*	White		
ESS0046LR*	Red	115VAC ±10%	25mA
ESS0046LW*	White		
ESS0048LR*	Red	230VAC ±10%	20mA
ESS0048LW*	White		

*Specify colour A = Amber, R = Red

**Synchronisation requires sounders to be connected to the same power supply

SON4

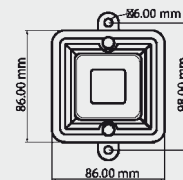
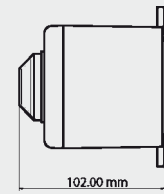

SON4L AC

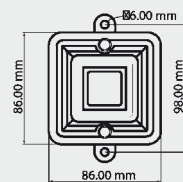
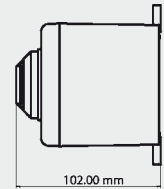

SON4L DC

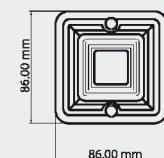
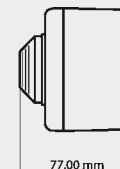

A100-AL100

- Electronic sounder and sounder beacon
- 32 tones, includes ISO tones to Australian Standards
- Automatic synchronisation on multi-sounder systems**
- Sounder and beacon controlled independently
- Volume control (100db max - 90dB min on tone 2)
- Three stage alarm (reverse polarity stage switching on DC units)
- IP66



Specifications:

Sound output: Max 104dB @ 1m
Sound frequency: 32 tones see tone list on page 11-38
Flash energy: 5J (xenon version)
Light output: Xenon 200cd(e)
 LED 120cd(e)
Flash rate: Xenon 60fpm
 LED 120fpm or steady
Protection: IP66
Temp rating (°C): -25 to +55
Cable entry: 3 x M20 knockouts
Rating: Continuous
Construction: Flame Retardant ABS

Order Code	Voltage	Current Sounder	Current Beacon	Weight (kg)
------------	---------	-----------------	----------------	-------------

A100 sounder				
ESS1010	10-30VDC	25mA @ 24VDC	-	0.26
ESS1012	24VAC ±10%	40mA	-	0.37
ESS1015	35-60VDC	50mA @ 48VDC	-	0.26
ESS1020	115VAC ±10%	20mA	-	0.37
ESS1030	230VAC ±10%	15mA	-	

AL100 sounder-beacon – with xenon beacon				
ESS1105*	10-14VDC	25mA	500mA	0.46
ESS1110*	20-28VDC	25mA	250mA	
ESS1112*	24VAC ±10%	40mA	300mA	0.57
ESS1115*	42-54VDC	50mA	175mA	0.46
ESS1120*	115VAC ±10%	20mA	70mA	0.57
ESS1130*	230VAC ±10%	15mA	35mA	

*Specify colour A = Amber, B = Blue, C = Clear, G = Green, R = Red

AL100 sounder-beacon – with H LED beacon				
ESS1110*LED	10-30VDC	25mA @ 24VDC	115mA @ 24VDC	0.46
ESS1120*LED	115VAC ±10%	20mA	70mA	0.57
ESS1130*LED	230VAC ±10%	15mA	35mA	

*Specify colour A = Amber, B = Blue, G = Green, R = Red
 Note lens colour on LED beacon is clear

**Synchronisation requires sounders to be connected to the same power supply

A100

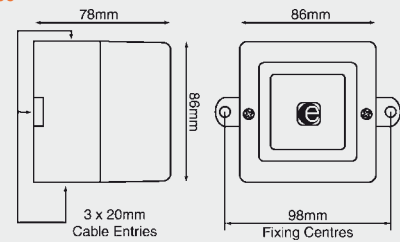

AL100

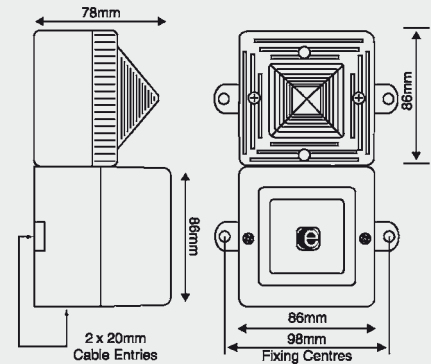

A105N-AL105N-AB105LDA

- Electronic sounder and sounder beacon
- 32 tones, includes ISO tones to Australian Standards
- Automatic synchronisation on multi-sounder systems**
- Sounder and beacon controlled independently
- Volume control (105dB max. - 96dB min on tone 2)
- Three stage alarm (reverse polarity stage switching on DC units)
- IP66



Specifications:

Sound output:	Max 112dB @ 1m
Sound frequency:	32 tones see tone list on page 11-38
Flash energy:	5J (xenon version)
Light output:	Xenon 200cd(e) LDA LED 19cd(e)
Flash rate:	Xenon 60fpm LDA LED – multi-function see list on page 11-6
Protection:	IP66 (IP65 on AB105LDA)
Temp rating (°C):	-25 to +55
Cable entry:	2 x M20 knockouts
Rating:	Continuous
Construction:	Flame Retardant ABS

A105N

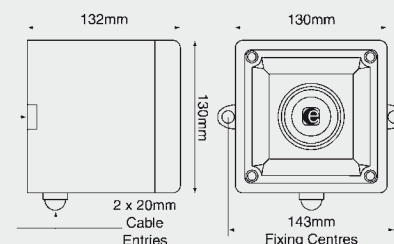

AL105N

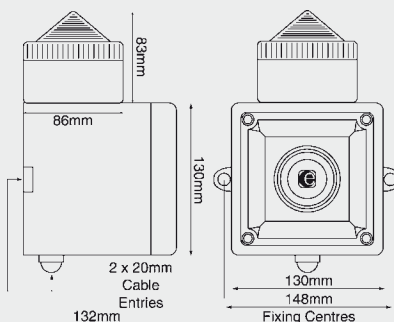

AB105LDA

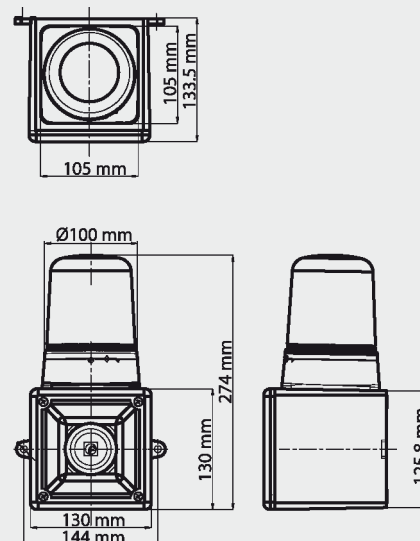

Order Code	Voltage	Current Sounder	Current Beacon	Weight (kg)
------------	---------	-----------------	----------------	-------------

A105N sounder

ESS2010N	10-30VDC	25mA @ 24VDC	-	0.75
ESS2012N	24VAC ±10%	40mA	-	1.00
ESS2015N	35-60VDC	50mA @ 48VDC	-	0.75
ESS2020N	115VAC ±10%	20mA	-	1.00
ESS2030N	230VAC ±10%	15mA	-	1.00

AL105N sounder-beacon – with xenon beacon

ESS2105N*	10-14VDC	25mA	500mA	0.95
ESS2110N*	20-28VDC	25mA	250mA	0.95
ESS2112N*	24VAC ±10%	40mA	300mA	1.20
ESS2115N*	42-54VDC	50mA	175mA	0.95
ESS2120N*	115VAC ±10%	20mA	70mA	1.20
ESS2130N*	230VAC ±10%	15mA	35mA	1.20

*Specify colour A = Amber, B = Blue, C = Clear, G = Green, R = Red

AB105LDA sounder-beacon – with multi-function LED beacon

ESSAB2110L*	10-30VDC	25mA @ 24VDC	130mA @ 24VDC	1.00
ESSAB2115L*	35-60VDC	50mA @ 48VDC	80mA @ 48VDC	1.00
ESSAB2120L*	115VAC ±10%	20mA	90mA	1.25
ESSAB2130L*	230VAC ±10%	15mA	50mA	1.25

*Specify colour A = Amber, B = Blue, G = Green, R = Red

**Synchronisation requires sounders to be connected to the same power supply

A112N-AL112N-AB112LDA

- Electronic sounder and sounder beacon
- 45 tones, includes ISO tones to Australian Standards
- Automatic synchronisation on multi-sounder systems**
- Sounder and beacon controlled independently
- Volume control (112dB max. - 100dB min. on tone 2)
- Three stage alarm (reverse polarity stage switching on DC units)***
- IP66



Specifications:

Sound output: Max 119dB @ 1m
Sound frequency: 45 tones see tone list on page 11-39
Flash energy: 5J (xenon version)
Light output: Xenon 200cd(e)
 LDA LED 19cd(e)
Flash rate: Xenon 60fpm
 LDA LED – multifunction see list on page 11-6
Protection: IP66 (IP65 on AB112LDA)
Temp rating (°C): -25 to +55
Cable entry: 2 x M20 knockouts
Rating: Continuous
Construction: Flame Retardant ABS

Order Code	Voltage	Current Sounder	Current Beacon	Weight (kg)
------------	---------	-----------------	----------------	-------------

A112N sounder

ESS3012N	10-30VDC	200mA @ 24VDC	-	1.80
ESS3013N	24VAC ±10%	500mA	-	2.10
ESS3016N	35-60VDC	120mA @ 48VDC	-	1.80
ESS3021N	115VAC ±10%	100mA	-	2.10
ESS3031N	230VAC ±10%	60mA	-	

AL112N sounder-beacon – with xenon beacon

ESS3106N*	10-14VDC	200mA	500mA	2.00
ESS3112N*	20-28VDC	200mA	250mA	
ESS3113N*	24VAC ±10%	500mA	300mA	2.30
ESS3116N*	42-54VDC	120mA	175mA	2.00
ESS3121N*	115VAC ±10%	100mA	70mA	2.30
ESS3131N*	230VAC ±10%	60mA	35mA	

*Specify colour A = Amber, B = Blue, C = Clear, G = Green, R = Red

AB112LDA sounder-beacon – with multi-function LED beacon

ESSAB3112L*	10-30VDC	200mA @ 24VDC	130mA @ 24VDC	2.10
ESSAB3116L*	35-60VDC	120mA @ 48VDC	80mA @ 48VDC	
ESSAB3121L*	115VAC ±10%	100mA	90mA	2.70
ESSAB3131L*	230VAC ±10%	60mA	50mA	

*Specify colour A = Amber, B = Blue, G = Green, R = Red

**Synchronisation requires sounders to be connected to the same power supply

***AB112LDA also features remote switching of 2nd and 3rd stage flash patterns on DC units

A112N

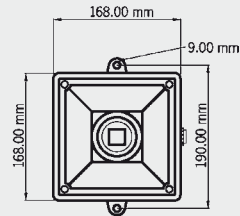
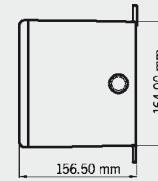

AL112N

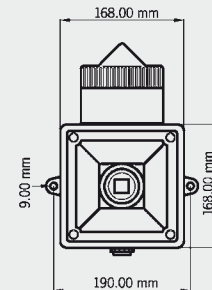
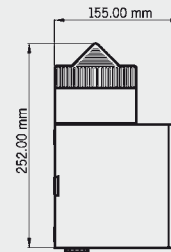

AB112LDA

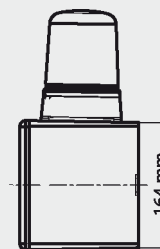
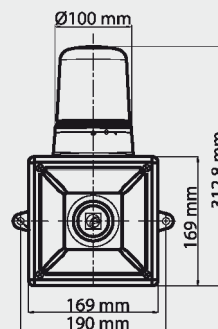
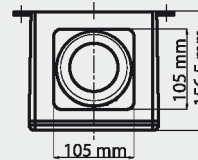

A121-AL121-AB121LDA-AB121STR

- Electronic sounder and sounder beacon
- 45 tones, includes ISO tones to Australian Standards
- Automatic synchronisation on multi-sounder systems**
- Sounder and beacon controlled independently
- Volume control (121dB max. - 112dB min. on tone 2)
- Three stage alarm (reverse polarity stage switching on DC units)***
- IP66



Specifications:

Sound output:	Max 126dB @ 1m
Sound frequency:	45 tones see tone list on page 11-39
Flash energy:	5J (AL121N) 15J (AB121STR)
Light output:	Xenon 200cd(e) (AL121) 500cd(e) (AB121STR) LDA LED 30cd(e)
Flash rate:	Xenon 60fpm (AB121STR has 3 flash patterns selectable on board) LDA LED – multifunction see list on page 11-7
Protection:	IP66 (IP65 on AB121LDA and AB121STR)
Temp rating (°C):	-25 to +55
Cable entry:	2 x M20 knockouts
Rating:	Continuous
Construction:	Flame Retardant ABS

Order Code	Voltage	Current Sounder	Current Beacon	Weight (kg)
------------	---------	-----------------	----------------	-------------

A121 sounder				
ESS5012	10-30VDC	950mA @ 24VDC	-	2.10
ESS5013	24VAC ±10%	1.0A	-	2.70
ESS5016	35-60VDC	600mA @ 48VDC	-	2.10
ESS5021	115VAC ±10%	240mA	-	2.70
ESS5031	230VAC ±10%	120mA	-	2.70

AL121 sounder-beacon – with 5J xenon beacon				
ESS5112*	20-28VDC	950mA	250mA	2.30
ESS5113*	24VAC ±10%	1.0A	300mA	2.90
ESS5116*	42-54VDC	600mA @ 48VDC	175mA	2.30
ESS5121*	115VAC ±10%	240mA	70mA	2.90
ESS5131*	230VAC ±10%	120mA	35mA	2.90

AB121STR sounder-beacon – with 15J xenon beacon				
ESSAB5112S*	20-28VDC	950mA	870mA	2.65
ESSAB5116S*	42-54VDC	600mA @ 48VDC	480mA	3.25
ESSAB5121S*	115VAC ±10%	240mA	400mA	3.25
ESSAB5131S*	230VAC ±10%	120mA	225mA	3.25

*Specify colour A = Amber, B = Blue, C = Clear, G = Green, R = Red

AB121LDA sounder-beacon – with multi-function LED beacon				
ESSAB5112L*	10-30VDC	200mA @ 24VDC	400mA @ 24VDC	2.65
ESSAB5116L*	35-60VDC	120mA @ 48VDC	400mA @ 48VDC	3.25
ESSAB5121L*	115VAC ±10%	100mA	140mA	3.25
ESSAB5131L*	230VAC ±10%	60mA	70mA	3.25

*Specify colour A = Amber, B = Blue, G = Green, R = Red

**Synchronisation requires sounders to be connected to the same power supply
 ***AB121LDA also features remote switching of 2nd and 3rd stage flash patterns on DC units

A121

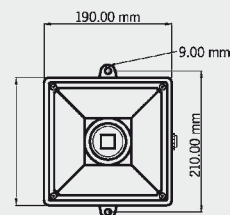
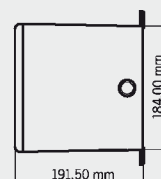

AB121LDA

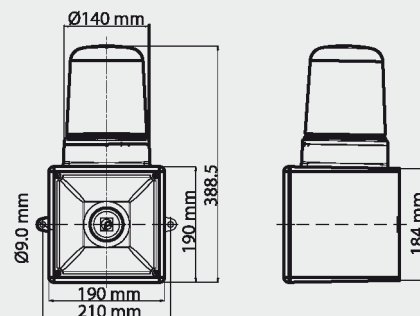
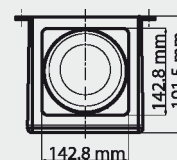

AL121

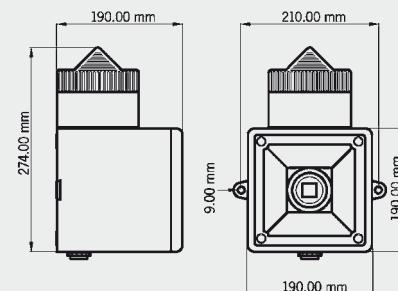

D105-DL105X-DL105H

- Heavy duty marine grade aluminium housing
- Electronic sounder and sounder beacon with choice of xenon or LED
- 32 tones, includes ISO tones to Australian Standards
- Automatic synchronisation on multi-sounder systems**
- Sounder and beacon controlled independently
- Volume control
- Three stage alarm (reverse polarity stage switching on DC units)
- IP66



Order Code	Voltage	Current Sounder	Current Beacon	Weight (kg)
D105 sounder red housing***				
ESSD2010	10-30VDC	25mA @ 24VDC	-	1.6
ESSD2012	24VAC ±10%	40mA	-	1.85
ESSD2015	35-60VDC	50mA @ 48VDC	-	1.6
ESSD2020	115VAC ±10%	20mA	-	1.85
ESSD2030	230VAC ± 10%	15mA	-	

DL105X sounder-beacon – with xenon beacon red housing***				
ESSD2105*	10-14VDC	25mA	380mA	2.10
ESSD2110*	20-28VDC	25mA	250mA	
ESSD2112*	24VAC ±10%	40mA	300mA	2.35
ESSD2115*	42-54VDC	50mA	175mA	2.10
ESSD2120*	115VAC ±10%	20mA	70mA	2.35
ESSD2130*	230VAC ± 10%	15mA	35mA	

*Specify lens colour A = Amber, B = Blue, C = Clear, G = Green, R = Red

DL105H sounder-beacon – with LED beacon red housing***				
ESSD2210*	10-30VDC	25mA @ 24VDC	157mA @ 24VDC	2.10
ESSD2215*	35-60VDC	50mA @ 48VDC	55mA @ 48VDC	
ESSD2220*	115VAC ±10%	20mA	60mA	2.35
ESSD2230*	230VAC ± 10%	15mA	35mA	

*Specify LED colour A = Amber, B = Blue, G = Green, R = Red

**Synchronisation requires sounders to be connected to the same power supply

***Grey (RAL7038) housing available on request

Specifications:

Maximum sound output: 112dB @ 1m
Nominal sound output: 105dB @ 1m (105dB max. - 65dB min. on tone 2 with volume control)
Sound frequency: 3 stages -32 tones see tone list on page 11-38
Flash energy: 5J (xenon version)
Light output: Xenon 200cd(e)
LED 176cd(e) (LED versions have clear lens with coloured LED's)
Xenon 60fpm
LED – steady or flashing 120fpm
Flash rate: IP66
Protection: Temp rating (°C): -25 to +55
Cable entry: 2 x M20 x 1.5mm threaded cable entries
Rating: Continuous
Construction: Marine grade aluminium A1 Si12 Cu

D105

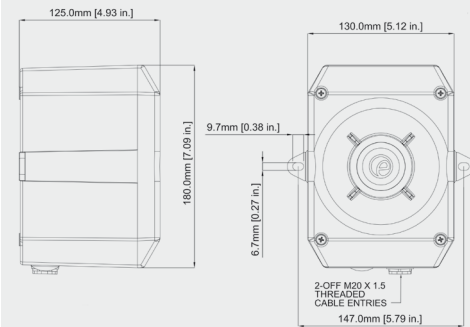

DL105

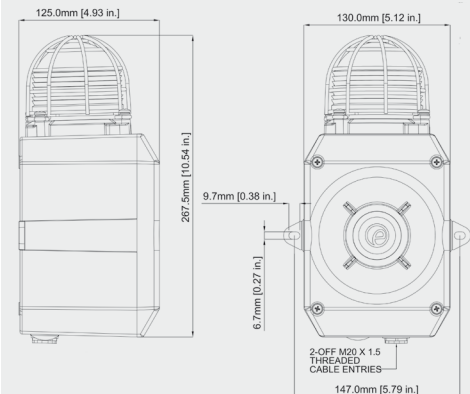

D112-DL112X-DL112H

- Heavy duty marine grade aluminium housing
- Electronic sounder and sounder beacon with choice of xenon or LED
- 45 tones, includes ISO tones to Australian Standards
- Automatic synchronisation on multi-sounder systems**
- Sounder and beacon controlled independently
- Volume control
- Three stage alarm (reverse polarity stage switching on DC units)
- IP66

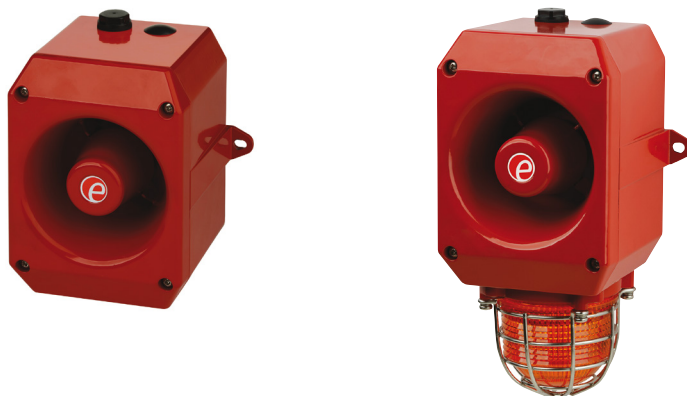

Specifications:

Maximum sound output: 119dB @ 1m
Nominal sound output: 112dB @ 1m 112dB max. - 100dB min. on tone 2 with volume control)
Sound frequency: 3 stages -45 tones see tone list on page 11-39
Flash energy: 5J (xenon version)
Light output: Xenon 200cd(e)
LED 176cd(e) (LED versions have clear lens with coloured LED's)
Xenon 60fpm
LED – steady or flashing 120fpm
Protection: IP66
Temp rating (°C): -25 to +55
Cable entry: 2 x M20 x 1.5mm threaded cable entries
Rating: Continuous
Construction: Marine grade aluminium A1 Si12 Cu

Order Code	Voltage	Current Sounder	Current Beacon	Weight (kg)
D112 sounder red housing***				
ESSD3010	10-30VDC	200mA @ 24VDC	-	1.6
ESSD3012	24VAC ±10%	500mA	-	1.85
ESSD3015	35-60VDC	120mA @ 48VDC	-	1.6
ESSD3020	115VAC ±10%	100mA	-	1.85
ESSD3030	230VAC ± 10%	60mA	-	1.85

DL112X sounder-beacon – with xenon beacon red housing***				
ESSD3105*	10-14VDC	200mA	380mA	2.80
ESSD3110*	20-28VDC	200mA	250mA	2.80
ESSD3112*	24VAC ±10%	500mA	300mA	3.10
ESSD3115*	42-54VDC	120mA	175mA	2.80
ESSD3120*	115VAC ±10%	100mA	70mA	3.10
ESSD3130*	230VAC ± 10%	60mA	35mA	3.10

*Specify lens colour A = Amber, B = Blue, C = Clear, G = Green, R = Red

DL112H sounder-beacon – with LED beacon red housing***				
ESSD3210*	10-30VDC	200mA @ 24VDC	157mA @ 24VDC	2.80
ESSD3215*	35-60VDC	120mA @ 48VDC	55mA @ 48VDC	2.80
ESSD3220*	115VAC ±10%	100mA	60mA	3.10
ESSD3230*	230VAC ± 10%	60mA	35mA	3.10

*Specify LED colour A = Amber, B = Blue, G = Green, R = Red

**Synchronisation requires sounders to be connected to the same power supply

***Grey (RAL7038) housing available on request

D112

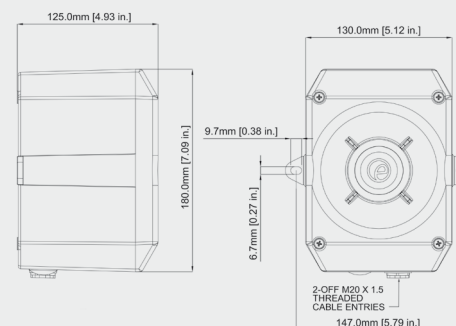

DL112

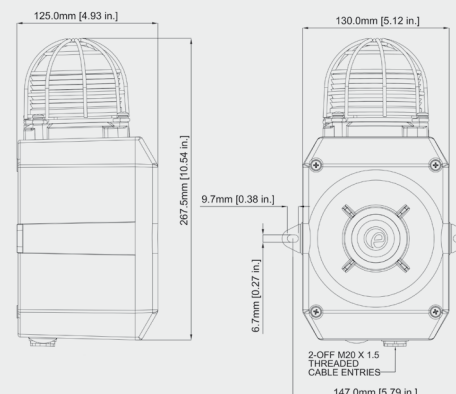

SONF1 DC Tones (SONFL1)

Stage 1	Description	Sound Output db@1m	Stage 2
Tone 1	500/1200Hz @ 0.3Hz 0.5 sec Slow Whoop	99dB	Tone 8
Tone 2	Slow whoop 500/1200Hz at 0.3Hz with 0.5 second gap repeated	100dB	Tone 1
Tone 3	1200/500Hz @ 1Hz - DIN / PFEER P.T.A.P	99dB	Tone 8
Tone 4	AS2220: 420Hz repeating 0.625 sec on, 0.625 sec off.	97dB	Tone 9
Tone 5	Bell	95dB	Tone 1
Tone 6	800/1000Hz @ 7Hz Sweeping	99dB	Tone 8
Tone 7	AS1670: 500-1200Hz Sweeping 2 sec on 1 sec off	100dB	Tone 10
Tone 8	1000Hz Continuous - PFEER Toxic Gas.	100dB	-
Tone 9	AS2220: 500-1200Hz Sweeping 3.75 sec on 0.25 sec off (15 cycles/min)	100dB	-
Tone 10	AS1670: 1500-500Hz 0.5 sec on 0.5 sec off x 3 with 1.5 sec gap	100dB	-

SONF1 AC Tones (SONFL1)

Stage 1	Description	Sound Output db@1m	Stage 2
Tone 1	800/1000Hz @ 0.25 sec Alternating	99dB	-
Tone 2	500/1200Hz @ 0.3Hz 0.5 sec Slow Whoop	100dB	-
Tone 3	1200/500Hz @ 1Hz - DIN / PFEER P.T.A.P.	99dB	-
Tone 4	AS1670: 1500-500Hz 0.5 sec on 0.5 sec off x 3 with 1.5 sec gap	100dB	-
Tone 5	1000Hz Continuous - PFEER Toxic Gas	100dB	-
Tone 6	Bell	95dB	-
Tone 7	AS1670: 500-1200Hz Sweeping 2 sec on 1 sec off	100dB	-
Tone 8	2400/2900Hz @ 50Hz Sweeping	100dB	-
Tone 9	AS2220: 420Hz repeating 0.625 sec on, 0.625 sec off.	97dB	-
Tone 10	AS2220: 500-1200Hz Sweeping 3.75 sec on 0.25 sec off (15 cycles/min)	100dB	-

SON2 – SON4 xenon Tones

Stage 1	Description	Sound Output db@1m	Stage 2	Stage 3
Tone 1	340 Hz Continuous	93dB	Tone 2	Tone 5
Tone 2	800/1000Hz @ 0.25 sec Alternating	101dB	Tone 17	Tone 5
Tone 3	500/1200Hz @ 0.3Hz 0.5 sec Slow Whoop	101dB	Tone 2	Tone 5
Tone 4	800/1000Hz @ 1Hz Sweeping	101dB	Tone 6	Tone 5
Tone 5	2400Hz Continuous	103dB	Tone 3	Tone 26
Tone 6	2400/2900Hz @ 7Hz Sweeping	100dB	Tone 7	Tone 5
Tone 7	2400/2900Hz @ 1Hz Sweeping	101dB	Tone 10	Tone 5
Tone 8	500/1200/500Hz @ 0.3Hz Sweeping	100dB	Tone 2	Tone 5
Tone 9	1200/500Hz @ 1Hz - DIN / PFEER P.T.A.P.	101dB	Tone 15	Tone 2
Tone 10	2400/2900Hz @ 2Hz Alternating	104dB	Tone 7	Tone 5
Tone 11	1000Hz @ 1Hz Intermittent	101dB	Tone 2	Tone 5
Tone 12	800/1000Hz @ 0.875Hz Alternating	101dB	Tone 4	Tone 5
Tone 13	2400Hz @ 1Hz Intermittent	103dB	Tone 15	Tone 5
Tone 14	800Hz 0.25 sec on, 1 sec off Intermittent	103dB	Tone 4	Tone 5
Tone 15	800Hz Continuous	103dB	Tone 2	Tone 5
Tone 16	AS2220: 420Hz repeating 0.625 sec on, 0.625 sec off.	91dB	Tone 18	Tone 5
Tone 17	544Hz (100mS)/440Hz (400mS) - NF S 32-001	100dB	Tone 2	Tone 27
Tone 18	AS2220: 500-1200Hz Sweeping 3.75 sec on 0.25 sec off (15 cycles/min)	100dB	Tone 16	Tone 5
Tone 19	1.4KHz-1.6KHz 1s, 1.6KHz-1.4KHz 0.5s -NFC48-265	98dB	Tone 2	Tone 5
Tone 20	660Hz Continuous	96dB	Tone 2	Tone 5
Tone 21	554Hz/440Hz @ 1Hz Alternating	100dB	Tone 2	Tone 5
Tone 22	544Hz @ 0.875 sec. Intermittent	100dB	Tone 2	Tone 5
Tone 23	800Hz @ 2Hz Intermittent	97dB	Tone 6	Tone 5
Tone 24	800/1000Hz @ 50Hz Sweeping	101dB	Tone 29	Tone 5
Tone 25	2400/2900Hz @ 50Hz Sweeping	101dB	Tone 29	Tone 5
Tone 26	1000Hz @ 1Hz Intermittent	101dB	Tone 5	Tone 15
Tone 27	554Hz Continuous	101dB	Tone 26	Tone 5
Tone 28	440Hz Continuous	97dB	Tone 2	Tone 5
Tone 29	800/1000Hz @ 7Hz Sweeping	101dB	Tone 7	Tone 5
Tone 30	AS1670: 1500-500Hz 0.5 sec on 0.5 sec off x 3 with 1.5 sec gap	100dB	Tone 32	Tone 26
Tone 31	660/1200Hz @ 1Hz Sweeping	101dB	Tone 26	Tone 5
Tone 32	AS1670: 500-1200Hz Sweeping 2 sec on 1 sec off	100dB	Tone 30	Tone 26

SON4L LED Tones

Stage 1	Description	Sound Output db@1m	Stage 2	Stage 3
Tone 1	800/1000Hz @ 0.25 sec Alternating	99dB	Tone 8	Tone 5
Tone 2	500/1200Hz @ 0.3Hz 0.5 sec Slow Whoop	100dB	Tone 1	Tone 8
Tone 3	1200/500Hz @ 1Hz - DIN / PFEER P.T.A.P.	99dB	Tone 1	Tone 8
Tone 4	AS1670: 1500-500Hz 0.5 sec on 0.5 sec off x 3 with 1.5 sec gap	100dB	Tone 7	Tone 2
Tone 5	1000Hz Continuous - PFEER Toxic Gas	100dB	Tone 1	Tone 6
Tone 6	Bell	95dB	Tone 1	Tone 8
Tone 7	AS1670: 500-1200Hz Sweeping 2 sec on 1 sec off	100dB	Tone 4	Tone 1
Tone 8	2400/2900Hz @ 50Hz Sweeping	100dB	Tone 5	Tone 1
Tone 9	AS2220: 420Hz repeating 0.625 sec on, 0.625 sec off.	97dB	Tone 10	Tone 5
Tone 10	AS2220: 500-1200Hz Sweeping 3.75 sec on 0.25 sec off (15 cycles/min)	100dB	Tone 6	Tone 5

A100-A105N Tones

Tone 1	340 Hz Continuous	93/102dB	Tone 2	Tone 5
Tone 2	800/1000Hz @ 0.25 sec Alternating	101/106dB	Tone 17	Tone 5
Tone 3	500/1200Hz @ 0.3Hz 0.5 sec Slow Whoop	101/106B	Tone 2	Tone 5
Tone 4	800/1000Hz @ 1Hz Sweeping	101/106dB	Tone 6	Tone 5
Tone 5	2400Hz Continuous	103/112dB	Tone 3	Tone 20
Tone 6	2400/2900Hz @ 7Hz Sweeping	100/108dB	Tone 7	Tone 5
Tone 7	2400/2900Hz @ 1Hz Sweeping	101/108dB	Tone 10	Tone 5
Tone 8	500/1200/500Hz @ 0.3Hz Sweeping	100/106dB	Tone 2	Tone 5
Tone 9	1200/500Hz @ 1Hz - DIN / PFEER P.T.A.P.	101/106dB	Tone 15	Tone 2
Tone 10	2400/2900Hz @ 2Hz Alternating	104/110dB	Tone 7	Tone 5
Tone 11	1000Hz @ 1Hz Intermittent	101/106dB	Tone 2	Tone 5
Tone 12	800/1000Hz @ 0.875Hz Alternating	101/106dB	Tone 4	Tone 5
Tone 13	2400Hz @ 1Hz Intermittent	103/112dB	Tone 15	Tone 5
Tone 14	800Hz 0.25 sec on, 1 sec off Intermittent	103/108dB	Tone 4	Tone 5
Tone 15	800Hz Continuous	103/108dB	Tone 2	Tone 5
Tone 16	AS2220: 420Hz repeating 0.625 sec on, 0.625 sec off.	91//103dB	Tone 18	Tone 5
Tone 17	544Hz (100mS)/440Hz (400mS) - NF S 32-001	100/104dB	Tone 2	Tone 27
Tone 18	AS2220: 500-1200Hz Sweeping 3.75 sec on 0.25 sec off (15 cycles/min)	100/106dB	Tone 16	Tone 5
Tone 19	1.4KHz-1.6KHz 1s, 1.6KHz-1.4KHz 0.5s -NFC48-265	98/106dB	Tone 2	Tone 5
Tone 20	660Hz Continuous	96/104dB	Tone 2	Tone 5
Tone 21	554Hz/440Hz @ 1Hz Alternating	100/104dB	Tone 2	Tone 5
Tone 22	544Hz @ 0.875 sec. Intermittent	100/104dB	Tone 2	Tone 5
Tone 23	800Hz @ 2Hz Intermittent	97/108dB	Tone 6	Tone 5
Tone 24	800/1000Hz @ 50Hz Sweeping	101/108dB	Tone 29	Tone 5
Tone 25	2400/2900Hz @ 50Hz Sweeping	101/108dB	Tone 29	Tone 5
Tone 26	1000Hz @ 1Hz Intermittent	101/106dB	Tone 5	Tone 15
Tone 27	554Hz Continuous	101/104dB	Tone 11	Tone 5
Tone 28	440Hz Continuous	97/103dB	Tone 2	Tone 5
Tone 29	800/1000Hz @ 7Hz Sweeping	101/105dB	Tone 7	Tone 5
Tone 30	AS1670: 1500-500Hz 0.5 sec on 0.5 sec off x 3 with 1.5 sec gap	100/106dB	Tone 32	Tone 26
Tone 31	660/1200Hz @ 1Hz Sweeping	101/105dB	Tone 26	Tone 5
Tone 32	AS1670: 500-1200Hz Sweeping 2 sec on 1 sec off	100/105dB	Tone 30	Tone 15

A112N - A121 - A131 - A141 - A105NAX - A121AX - MA112 - MA121 - MCA112-05 - D105 - D112 Tones

Stage 1	Description	Sound Output db@1m	Stage 2	Stage 3
Tone 1	340 Hz Continuous	107/113dB	Tone 2	Tone 5
Tone 2	800/1000Hz @ 0.25 sec Alternating	112/121dB	Tone 17	Tone 5
Tone 3	500/1200Hz @ 0.3Hz 0.5 sec Slow Whoop	113/121dB	Tone 2	Tone 5
Tone 4	800/1000Hz @ 1Hz Sweeping	113/121dB	Tone 6	Tone 5
Tone 5	2400Hz Continuous	119/125dB	Tone 3	Tone 20
Tone 6	2400/2900Hz @ 7Hz Sweeping	116/123dB	Tone 7	Tone 5
Tone 7	2400/2900Hz @ 1Hz Sweeping	116/125dB	Tone 10	Tone 5
Tone 8	500/1200/500Hz @ 0.3Hz Sweeping	113/121dB	Tone 2	Tone 5
Tone 9	1200/500Hz @ 1Hz - DIN / PFEER P.T.A.P.	113/121dB	Tone 15	Tone 2
Tone 10	2400/2900Hz @ 2Hz Alternating	119/126dB	Tone 7	Tone 5
Tone 11	1000Hz @ 1Hz Intermittent	112/121dB	Tone 2	Tone 5
Tone 12	800/1000Hz @ 0.875Hz Alternating	112/121dB	Tone 4	Tone 5
Tone 13	2400Hz @ 1Hz Intermittent	119/125dB	Tone 15	Tone 5
Tone 14	800Hz 0.25 sec on, 1 sec off Intermittent	113/120dB	Tone 4	Tone 5
Tone 15	800Hz Continuous	113/120dB	Tone 2	Tone 5
Tone 16	AS1670: 500-1200Hz Sweeping 2 sec on 1 sec off	113/121dB	Tone 18	Tone 5
Tone 17	544Hz (100mS)/440Hz (400mS) - NF S 32-001	109/118dB	Tone 2	Tone 27
Tone 18	AS1670: 1500-500Hz 0.5 sec on 0.5 sec off x 3 with 1.5 sec gap	113/121dB	Tone 16	Tone 5
Tone 19	1.4KHz-1.6KHz 1s, 1.6KHz-1.4KHz 0.5s -NFC48-265	114/126dB	Tone 2	Tone 5
Tone 20	660Hz Continuous	109/118dB	Tone 2	Tone 5
Tone 21	554Hz/440Hz @ 1Hz Alternating	109/118dB	Tone 2	Tone 5
Tone 22	544Hz @ 0.875 sec. Intermittent	109/118dB	Tone 2	Tone 5
Tone 23	800Hz @ 2Hz Intermittent	113/120dB	Tone 6	Tone 5
Tone 24	800/1000Hz @ 50Hz Sweeping	112/120dB	Tone 29	Tone 5
Tone 25	2400/2900Hz @ 50Hz Sweeping	116/124dB	Tone 29	Tone 5
Tone 26	Bell	108/118dB	Tone 2	Tone 15
Tone 27	554Hz Continuous	109/117dB	Tone 26	Tone 5
Tone 28	440Hz Continuous	106/117dB	Tone 2	Tone 5
Tone 29	800/1000Hz @ 7Hz Sweeping	112/121dB	Tone 7	Tone 5
Tone 30	300Hz Continuous	107/114dB	Tone 2	Tone 5
Tone 31	660/1200Hz @ 1Hz Sweeping	112/121dB	Tone 26	Tone 5
Tone 32	Two tone chime.	108/118dB	Tone 26	Tone 15
Tone 33	745Hz @ 1Hz Intermittent	109/116dB	Tone 2	Tone 5
Tone 34	1000 & 2000Hz @ 0.5 sec Alternating - Singapore	109/121dB	Tone 38	Tone 45
Tone 35	AS2220: 420Hz @ 0.625 sec Australian Alert	106/117dB	Tone 36	Tone 5
Tone 36	AS2220: 500-1200Hz 3.75 sec /0.25 sec. Australian Evac.	113/121dB	Tone 35	Tone 5
Tone 37	1000Hz Continuous - PFEER Toxic Gas	113/121dB	Tone 9	Tone 45
Tone 38	2000Hz Continuous	112/120dB	Tone 34	Tone 45
Tone 39	800Hz 0.25 sec on, 1 sec off Intermittent	116/120dB	Tone 23	Tone 17
Tone 40	544Hz (100mS)/440Hz (400mS) - NF S 32-001	113/121dB	Tone 31	Tone 27
Tone 41	Motor Siren - slow rise to 1200 Hz	112/122dB	Tone 2	Tone 5
Tone 42	Motor Siren - slow rise to 800 Hz	114/121dB	Tone 2	Tone 5
Tone 43	1200 Hz Continuous	113/122dB	Tone 2	Tone 5
Tone 44	Motor Siren - slow rise to 2400 Hz	118/124dB	Tone 2	Tone 5
Tone 45	1KHz 1s on, 1s off Intermittent - PFEER Gen. Alarm	112/121dB	Tone 38	Tone 34

Y03



- Electronic sounder
- 32 tones
- 2 stage alarm
- Volume control (-18dB adjustment)
- IP65

Order Code	Voltage	Current	Weight (kg)
YOD3021	12-35VDC	20-67mA	0.32
YOD3041	48VDC	35mA	
YOD3071	115VAC ±10%	25mA	0.39
YOD3081	230VAC ±10%	20mA	

Specifications:

Sound output*: Max 100dB @1m
 Sound frequency: 32 Tones see tone list on page 11-42
 Protection: IP65
 Temp rating (°C): -25 to +55
 Rating: Continuous
 Cable entry: 2 x 20mm
 Construction: Flame retardant ABS

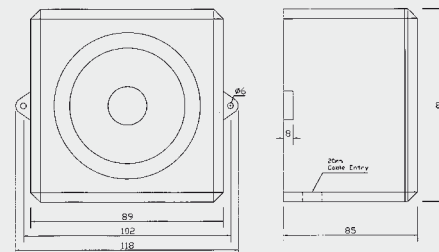

Dimensions in mm

Y04 – YL4-V4

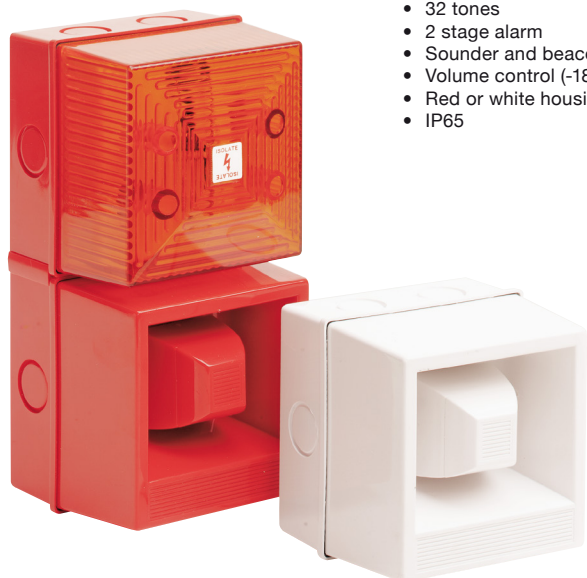

- Electronic sounder, beacon or sounder/beacon combination
- 32 tones
- 2 stage alarm
- Sounder and beacon controlled independently
- Volume control (-18dB adjustment)
- Red or white housing
- IP65

Specifications:

Sound output*: Max 106dB @1m
 Sound frequency: 32 Tones see tone list on page 11-42
 Flash energy: 5J
 Light output: 72cd(e) (with clear lens)
 Flash rate: 60fpm
 Protection: IP65
 Temp rating (°C): -25 to +55
 Rating: Continuous
 Cable entry: 2 x 20mm
 Construction: Flame retardant ABS

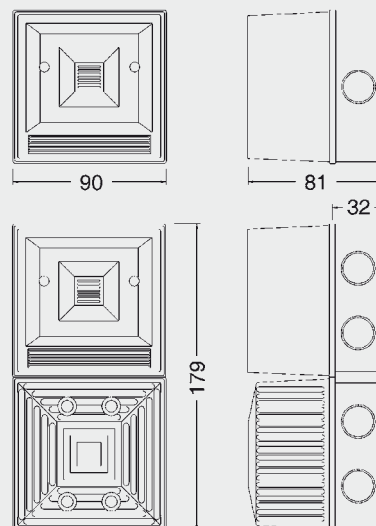

Dimensions in mm

Order Code	Voltage	Current Sounder	Current Beacon	Weight (kg)
Y04 (YA40) sounder				
YOD1800#	24VDC	37mA	-	0.25
YOD1801#	115VAC ±10%	27mA	-	0.35
YOD1802#	230VAC ±10%	21mA	-	
YL4 (YL40) sounder-beacon				
YOD1810#*	24VDC	35mA	306mA	0.51
YOD1811#*	115VAC ±10%	25mA	100mA	0.57
YOD1812#*	230VAC ±10%	13mA	98mA	

#Specify housing colour R = Red, W = White

*Specify lens colour A = Amber, B = Blue, C = Clear, G = Green, R = Red

V4 (FL40) beacon red housing

YOD2020*	24VDC	-	306mA	0.26
YOD2030*	50VDC	-	157mA	
YOD2040*	115VAC ±10%	-	100mA	0.25
YOD2050*	230VAC ± 10%	-	98mA	

*Specify lens colour A = Amber, B = Blue, C = Clear, G = Green, R = Red



Y05 – YL5

- Electronic sounder or sounder/beacon combination
- 32 tones
- 2 stage alarm
- Sounder and beacon controlled independently
- Volume control (-18dB adjustment)
- IP65

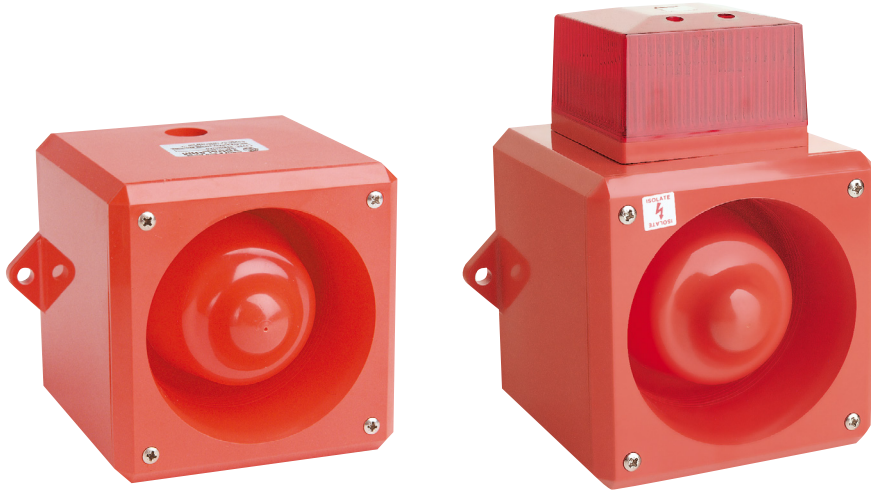

Specifications:

Sound output*:	Max 110dB @1m
Sound frequency:	32 Tones see tone list on page 11-42
Flash energy:	5J
Light output:	14cd(e)
Flash rate:	60fpm
Protection:	IP65
Temp rating (°C):	-25 to +55
Rating:	Continuous
Cable entry:	2 x 20mm
Construction:	Flame retardant ABS

Order Code	Voltage	Current Sounder	Current Beacon	Weight (kg)
Y05 (YA50) sounder				
Y0D5021	12-35VDC	20-67mA	-	0.71
Y0D5041	48VDC	35mA	-	
Y0D5071	115VAC ±10%	25mA	-	0.81
Y0D5081	230VAC ±10%	20mA	-	
YL5 (YL50) sounder-beacon				
Y0D5121*	24VDC	67mA	250mA	1.010
Y0D5131*	48VDC	35mA	135mA	
Y0D5141*	115VAC ±10%	25mA	130mA	1.090
Y0D5151*	230VAC ±10%	20mA	70mA	

*Specify lens colour A = Amber, B = Blue, C = Clear, G = Green, R = Red

Y05

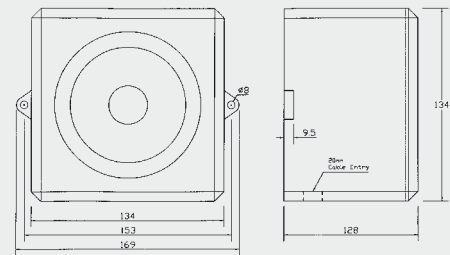

Dimensions in mm

YL5

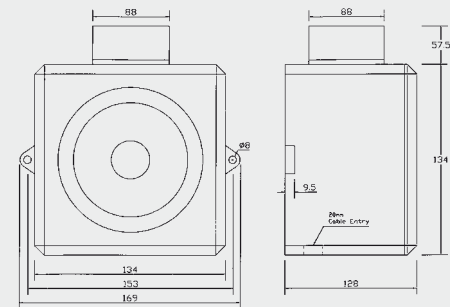

Dimensions in mm



Y08 – YL8

- Electronic sounder or sounder/beacon combination
- 32 tones
- 2 stage alarm
- Sounder and beacon controlled independently
- IP65

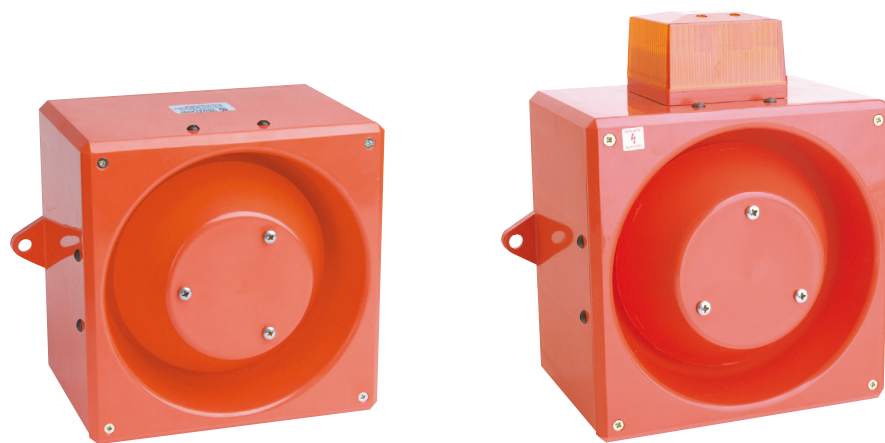

Specifications:

Sound output*:	Max 116dB @1m
Sound frequency:	32 Tones see tone list below
Flash energy:	5J
Light output:	14cd(e)
Flash rate:	60fpm
Protection:	IP65
Temp rating (°C):	-25 to +55
Rating:	Continuous
Cable entry:	2 x 20mm
Construction:	Flame retardant ABS

Y08

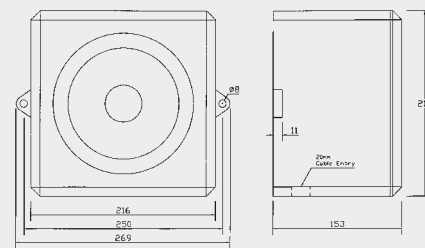

YL8

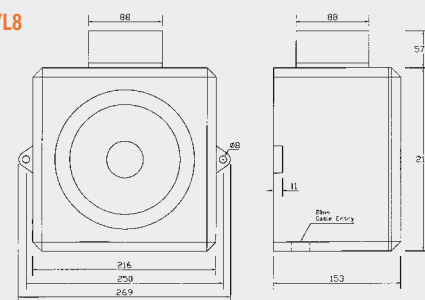

Order Code	Voltage	Current Sounder	Current Beacon	Weight (kg)
Y08 (YA80) sounder				
Y0D8021	12-35VDC	300-330mA	-	2.90
Y0D8041	48VDC	300mA	-	
Y0D8071	115VAC ±10%	102mA	-	3.280
Y0D8081	230VAC ±10%	45mA	-	
YL8 (YL80) sounder-beacon				
Y0D8121*	24VDC	300mA	250mA	3.210
Y0D8131*	48VDC	300mA	135mA	
Y0D8141*	115VAC ±10%	282mA	130mA	3.580
Y0D8151*	230VAC ±10%	225mA	70mA	

*Specify lens colour A = Amber, B = Blue, C = Clear, G = Green, R = Red

Y03-Y04-Y05-Y08 Tones

Stage 1	Description	Stage 2	Stage 1	Description	Stage 2
Tone 1	800-1000Hz @ 0.25s alternating	Tone 3	Tone 17	1000Hz @ 0.5s intermittent	Tone 1
Tone 2	2500-3100Hz @ 0.25s alternating	Tone 4	Tone 18	2500Hz @ 0.25s intermittent	Tone 4
Tone 3	800-1000Hz @ 0.25s alternating	Tone 7	Tone 19	2500Hz @ 0.5s intermittent	Tone 2
Tone 4	2500-3100Hz @ 0.25s alternating	Tone 8	Tone 20	700Hz 0.6s on, 1.2s off	Tone 10
Tone 5	440Hz 0.4s, 0554Hz 0.1s	Tone 14	Tone 21	1000Hz @ 1s intermittent	Tone 32
Tone 6	430-470Hz @ 1s alternating	Tone 14	Tone 22	700Hz @ 4s intermittent	Tone 10
Tone 7	800-1000Hz @ 0.13s alternating	Tone 12	Tone 23	700Hz @ 0.25s intermittent	Tone 10
Tone 8	2500-3200Hz @ 0.07s alternating	Tone 13	Tone 24	720Hz 0.7s on, 0.3s off	Tone 10
Tone 9	440-554Hz @ 2s alternating	Tone 10	Tone 25	1400Hz @0.25s intermittent fast rising	Tone 26
Tone 10	700Hz continuous	Tone 1	Tone 26	250-1200Hz 0.085s fast siren	Tone 11
Tone 11	1000Hz continuous	Tone 31	Tone 27	1000Hz rising	Tone 17
Tone 12	1000Hz continuous	Tone 7	Tone 28	800-1000Hz ISO8201 evac.	Tone 11
Tone 13	2300Hz continuous	Tone 2	Tone 29	500-1000Hz @ 0.15s fast whoop	Tone 32
Tone 14	440Hz continuous	Tone 9	Tone 30	500-1200Hz 4.5s slow whoop	Tone 12
Tone 15	1000Hz @ 0.25s intermittent	Tone 31	Tone 31	1200-500Hz 1s reverse sweep	Tone 11
Tone 16	420Hz @ 1.25s intermittent	Tone 30	Tone 32	500-1200Hz 3s siren	Tone 26



A105NAX-A121AX Appello X

- Electronic voice and tone sounder
- Records, stores and plays back user defined voice messages
- 4 x 30s messages
- High voice and music reproduction quality
- Message creation via built in microphone or line-in audio input
- 45 tones
- 4 tone stage
- Independent volume control for tone and message
- For multiple installations it is necessary to record messages only once on a master unit
- Optional LED beacon
- IP66
- Also available in D aluminium housing see p11-35-36

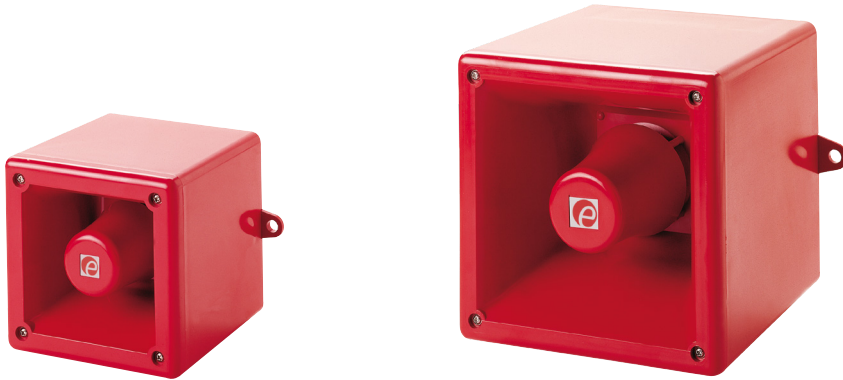

Order Code	Voltage	Current	Weight (kg)
A105NAX Appello			
ESS2010NAPX	10-30VDC	256mA @ 24VDC	0.8
ESS2030NAPX	90-260VAC	124mA @ 230VAC	1.0
A121AX Appello			
ESS5012APX	14-30VDC	1.51A @ 24VDC	2.1
ESS5031APX	90-260VAC	517mA	2.7
AL105NAX Appello with LED beacon**			
ESS2110NAPX*	10-30VDC	413mA @ 24VDC	1.0
ESS2130NAPX*	90-260VAC	159mA @ 230VAC	1.2
AL121AX Appello with LED beacon**			
ESS5112APX*	14-30VDC	1.67A @ 24VDC	2.3
ESS5131APX*	90-260VAC	567mA	2.9

*Specify colour A = Amber, B = Blue, C = Clear, G = Green, R = Red

**Note: beacon specifications on page 11-10 (L101H)

Specifications:

Sound output:
A105NAX
 Tone – Max 110dB @ 1m
 Voice – Max 101dB @ 1m
A121AX
 Tone – Max 126dB @ 1m
 Voice – Max 111dB @ 1m
 45 tones see tone list on page 11-39 – Note 4th stage tone is tone 29 regardless of 1st stage tone selected

Sound frequency:
 4 (total of 120 seconds)

No. messages:
 4

Protection:
 IP66

Temp rating (°C):
 -25 to +55

Rating:
 Continuous

Cable entry:
 2 x M20 knockouts

Rating:
 Continuous

Construction:
 Flame Retardant ABS

A105NAX

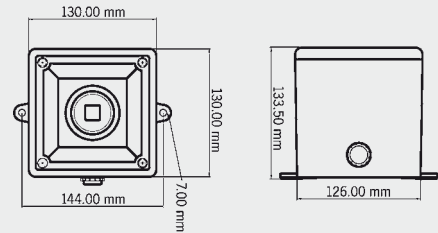

A105NAX

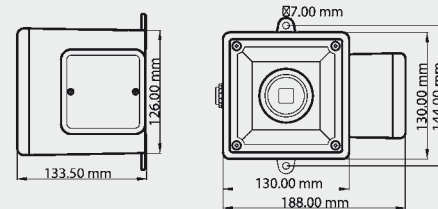

A121

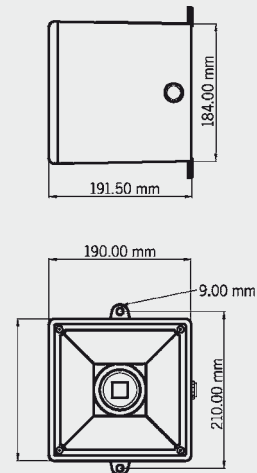

Micro series

- Small motor driven siren
- Surface or panel mount version (low voltage only)
- For indoor applications
- Double insulated
- IP42



Order Code*	Voltage	Current	Sound Frequency	Sound Output dB@1m
Micro W10 N – surface mounting				
SIR4001210	12VDC	1.1A	1350Hz	94dB
SIR4001220	12VAC			
SIR4002410	24VDC	650mA	1500Hz	96dB
SIR4002420	24VAC			
Micro W10 R – panel mounting				
SIR4001211	12VDC	1.1A	1350Hz	94dB
SIR4002411	24VDC	650mA	1500Hz	96dB
Micro W10 AT – surface mounting				
SIR4011020	110VAC	130mA	1000Hz	93dB
SIR4024020	240VAC	95mA	1450Hz	

Specifications:

Duty cycle:	Continuous
Voltage tolerance:	±10%
Protection:	IP42
Temp rating (°C):	-30 to +40
Cable entry:	Through base
Construction:	Polycarbonate
Weight:	0.15kg (low voltage) 0.60kg (mains voltage)

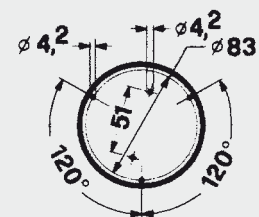
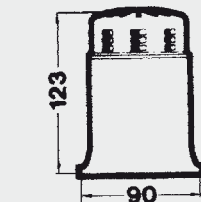
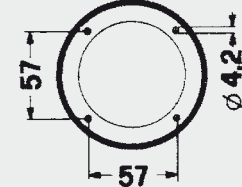
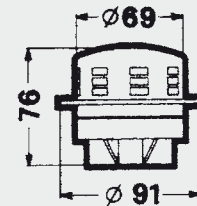
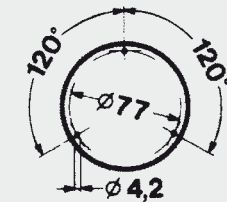
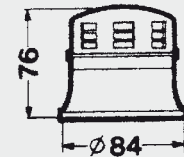

Dimensions in mm

Celere series

- Motor driven sirens up to 114dB
- 3 sizes
- Double insulated
- IP43



Order Code*	Voltage	Current	Sound Frequency	Sound Output dB@1m	Weight (kg)
Mini Celere (BA) – continuously rated					
SIR4101210	12VDC	1.3A	1200Hz	97dB	0.3
SIR4102410	24VDC	0.55A	1300Hz	100dB	
Mini Celere					
SIR4101230	12VAC/DC	2.7A	1020Hz	88dB	0.4
SIR4102430	24VAC/DC	1.47A	1350Hz	94dB	
SIR4104830	48VAC/DC	0.85A	1520Hz	100dB	
SIR4111030	110VAC/DC	0.37A	1450Hz	96dB	
SIR4124030	240VAC/DC	0.22A	1730Hz	101dB	
Celere (BA) – continuously rated					
SIR4301210	12VDC	2.5A	950Hz	103dB	0.6
SIR4302410	24VDC	1.1A	950Hz	103dB	
Celere					
SIR4301230	12VAC/DC	9.2A	1020Hz	100dB	1.2
SIR4302430	24VAC/DC	7.8A	1380Hz	109dB	
SIR4304830	48VAC/DC	3.6A	1410Hz	108.5dB	
SIR4311030	110VAC/DC	0.92A	1060Hz	104.5dB	
SIR4324030	240VAC/DC	0.65A	1430Hz	110dB	
Super Celere (BA) – continuously rated					
SIR4501210	12VDC	9.5A	820Hz	114dB	1.5
SIR4502410	24VDC	5.0A	820Hz	114dB	
Super Celere					
SIR4501230	12VAC/DC	13.5A	800Hz	111dB	1.6
SIR4502430	24VAC/DC	7.0A	900Hz	112dB	
SIR4504830	48VAC/DC	6.0A	1060Hz	113.5dB	
SIR4511030	110VAC/DC	1.7A	970Hz	111.5dB	
SIR4524030	240VAC/DC	1.2A	1120Hz	113.5dB	

Specifications:

Duty cycle:	1 min on. 10 min off (BA versions are continuously rated)
Voltage tolerance:	±10%
Protection:	IP43
Temp rating (°C):	-30 to +40
Cable entry:	M12
Construction:	Polycarbonate

Mini Celere

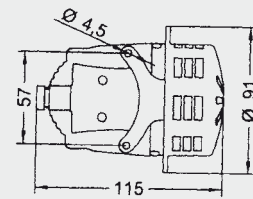
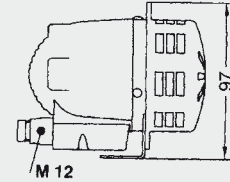

Celere

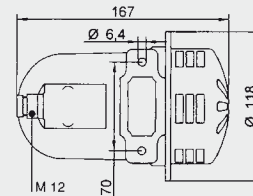
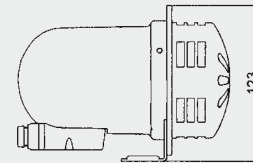

Super Celere

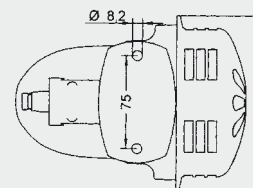
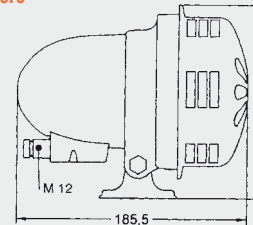

Dimensions in mm

Celerest series

- Motor driven sirens up to 116dB
- 3 sizes
- Vertical mounting with rain hood
- Double insulated
- IP44



Specifications:

Duty cycle:	1 min on. 10 min off (BA versions are continuously rated)
Voltage tolerance:	±10%
Protection:	IP44
Temp rating (°C):	-30 to +40
Cable entry:	M16
Construction:	Polycarbonate

Mini Celerest

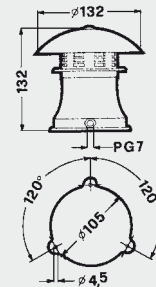

Celerest

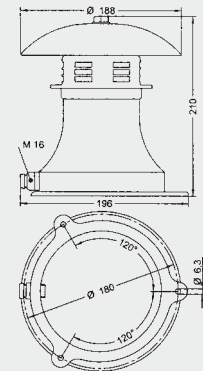

Super Celerest

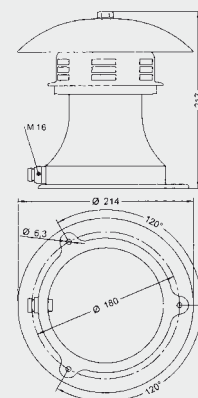

Dimensions in mm

Order Code*	Voltage	Current	Sound Frequency	Sound Output dB@1m	Weight (kg)
Mini Celerest (BA) – continuously rated					
SIR4701210	12VDC	1.3A	1200Hz	92dB	0.35
SIR4702410	24VDC	0.55A	1300Hz	95dB	
Mini Celerest					
SIR4701230	12VAC/DC	2.7A	1600Hz	96dB	0.45
SIR4702430	24VAC/DC	1.47A	1600Hz	97dB	
SIR4704830	48VAC/DC	0.85A	1650Hz	97dB	
SIR4711030	110VAC/DC	0.37A	1500Hz	95dB	
SIR4724030	240VAC/DC	0.22A	1700Hz	97dB	
Celerest (BA) – continuously rated					
SIR4801210	12VDC	2.5A	950Hz	100dB	0.9
SIR4802410	24VDC	1.1A	950Hz	100dB	
Celerest					
SIR4801230	12VAC/DC	9.2A	1150Hz	104dB	1.5
SIR4802430	24VAC/DC	7.8A	1250Hz	106dB	
SIR4804830	48VAC/DC	3.6A	1350Hz	106dB	
SIR4811030	110VAC/DC	0.92A	1300Hz	106dB	
SIR4824030	240VAC/DC	0.65A	1400Hz	107dB	
Super Celerest (BA) – continuously rated					
SIR4901210	12VDC	9.5A	820Hz	113dB	1.8
SIR4902410	24VDC	5.0A	820Hz	113dB	
Super Celerest					
SIR4901230	12VAC/DC	13.5A	900Hz	113dB	1.9
SIR4902430	24VAC/DC	7.0A	900Hz	114dB	
SIR4904830	48VAC/DC	6.0A	1000Hz	115dB	
SIR4911030	110VAC/DC	1.7A	1000Hz	115dB	
SIR4924030	240VAC/DC	1.2A	1050Hz	116dB	

Super M



- Sound output 127dB @ 1m
- Continuous rating
- Weatherproof (when mounted with rotor end down)

Order Code	Voltage	Current
SECXSM110	110VAC/DC	3.4A
SECXSM240	240VAC/DC	2.0A

Specifications:

Sound output: 127dB @ 1m (240V)
Sound frequency: 1600 Hz
Protection: IP55 (when mounted with rotor end down)
Rating: Continuous
Voltage tolerance: ±10%
Temperature range (°C): -30 to +45
Cable Entry: Through base
Construction: ABS
Weight: 1.8Kg

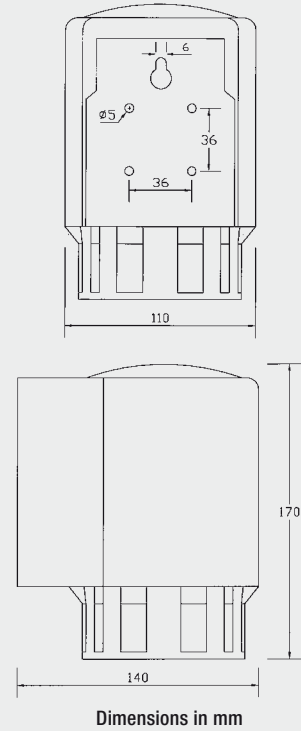

Dimensions in mm

S04



- Sound output 125dB @ 1m
- Low penetrating tone
- Continuous rating
- Weatherproof
- Robust aluminium construction

Order Code	Voltage	Current	Sound Output
SEC1310	110VAC/DC	3.7A	125dB @1m
SEC1340	240VAC/DC	2.1A	125dB @1m

Specifications:

Sound frequency: 900Hz
Protection: IP55
Rating: 20 min
Voltage tolerance: ±10%
Temperature rating (°C): -30 to +45
Cable entry: 20 mm
Construction: Aluminium alloy
Weight: 4.5Kg

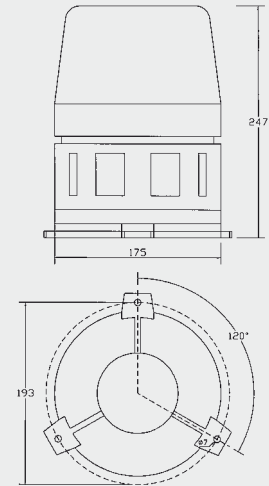

Dimensions in mm

Banshee Mono S



- Sound output up to 123dB @ 1m
- Robust die cast aluminium housing
- Continuous rating
- IP65

Order Code	Voltage	Current
KAMMS012	12VDC	15A
KAMMS024	24VDC	10.6A
KAMMS110	110VAC/DC	1.5A
KAMMS230	230VAC/DC	1.0A

Specifications:

Sound output: 123dB @ 1m (240V)
Sound frequency: 905-1200 Hz (depending on voltage)
Protection: IP65
Rating: Continuous (with thermal protector)
Voltage tolerance: ±10%
Temperature range (°C): -30 to +45
Cable Entry: 2 x M20
Construction: Powder coated aluminium
Weight: 1.66Kg

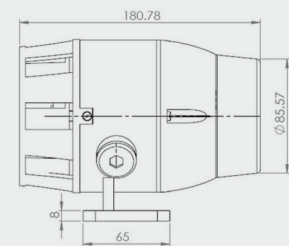
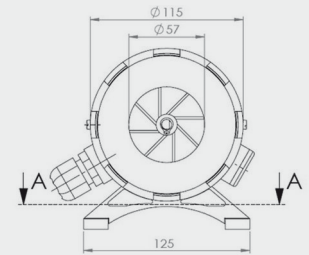

Dimensions in mm

Banshee Duplo S



- Sound output up to 127dB @ 1m
- Robust die cast aluminium housing
- Continuous rating
- IP65

Order Code	Voltage	Current
KAMDS110	110VAC/DC	1.6A
KAMDS230	230VAC/DC	1.1A

Specifications:

Sound output: 127dB @ 1m (240V)
Sound frequency: 1600 Hz
Protection: IP65
Rating: Continuous (with thermal protector)
Voltage tolerance: ±10%
Temperature range (°C): -30 to +45
Cable Entry: 3 x M20
Construction: Powder coated aluminium
Weight: 2.9Kg

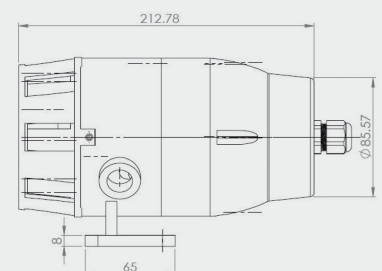
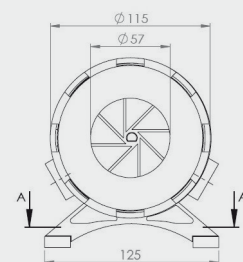

Dimensions in mm

MicroSAI



- High output buzzer
- Continuous or pulsing versions
- Surface or panel mounting versions
- Double insulated
- IP65

Order Code*	Voltage	Current
MicroSAI continuous sound surface mounting		
SIR8050125	12VAC	830mA
SIR8050245	24VAC	415mA
SIR8050485	48VAC	210mA
SIR8051105	110VAC	90mA
SIR8052405	240VAC	42mA
MicroSAI pulsing sound surface mounting		
SIR8050126	12VAC	830mA
SIR8050246	24VAC	415mA
SIR8050486	48VAC	210mA
SIR8051106	110VAC	90mA
SIR8052406	240VAC	42mA

* Add P to code for panel mounting version

Sound output: 95dB @ 1m
 Sound frequency: 300-350 Hz
 Duty cycle: Continuous
 Voltage tolerance: ±10%
 Protection: IP65
 Temp rating (°C): -30 to +40
 Cable entry: M16
 Construction: ABS and polycarbonate
 Weight: 0.31-0.42Kg

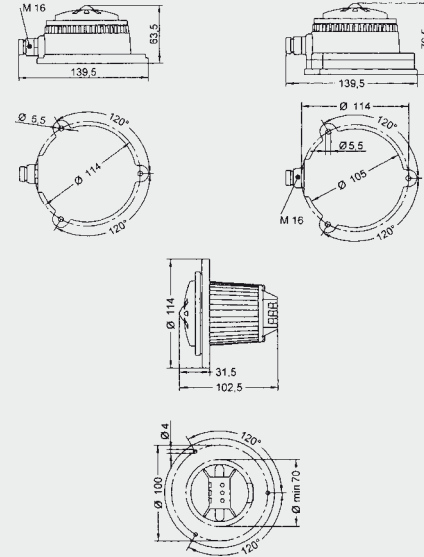

Dimensions in mm

SAI



- High output buzzer
- Continuous or pulsing versions
- Double insulated
- IP54

Order Code	Voltage	Current
SAI continuous sound		
SIR8070121	12VDC	1.7A
SIR8070241	24VDC	900mA
SIR8070481	48VDC	450mA
SIR8070125	12VAC	1.9A
SIR8070245	24VAC	1.1A
SIR8070485	48VAC	540mA
SIR8071105	110VAC	190mA
SIR8072405	240VAC	130mA
SAI pulsing sound		
SIR8070126	12VAC	1.9A
SIR8070246	24VAC	1.1A
SIR8070486	48VAC	540mA
SIR8071106	110VAC	190mA
SIR8072406	240VAC	130mA

Specifications:
 Sound output: 110dB @ 1m DC voltage, 105dB @1m AC voltage
 Sound frequency: 600-20000 Hz (800-15000Hz on AC supply)
 Duty cycle: Continuous
 Voltage tolerance: ±10%
 Protection: IP54
 Temp rating (°C): -30 to +40
 Cable entry: M16
 Construction: ABS and polycarbonate
 Weight: 0.7Kg

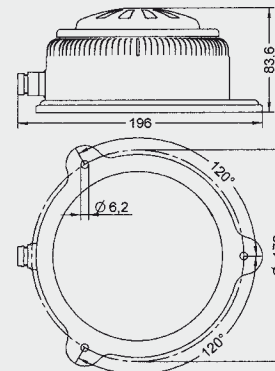

Dimensions in mm

HPT



- Electromechanical horn
- Impact resistant synthetic housing
- Wide choice of voltages in AC and DC
- IP55

Order Code	Voltage	Current
JA712100004	12VDC	1.0A
JA712100005	24VDC	600mA
JA712100010	110VDC	200mA
JA712100013	220VDC	100mA
JA712100105	24VAC	1.2A
JA712100110	110VAC	200mA
JA712100113	230VAC	100mA

Specifications:

Sound output: 108dB @ 1m
Duty cycle: Continuous
Protection: IP55
Temp rating (°C): -20 to +50
Cable entry: Cable gland 7-10mm
Mounting: with sound outlet down
Construction: ABS
Weight: 0.8Kg

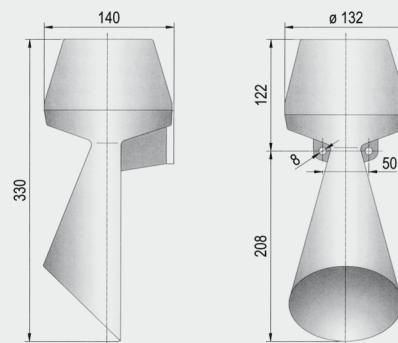

Dimensions in mm

HMA121



- Electronic horn/bell with 5 commonly used electro-mechanical sounds with 3 stage alarm
- Accurately reproduces electro-mechanical horn and bell sounds
- Automatically synchronises on multi-sounder systems.*
- High sound output (up to 121dB @ 1m)
- Volume control (124dB max. - 115dB min.)
- IP66

Order Code	Voltage	Current	Weight (kg)
ESS8210	24VDC	1.0A	2.5
ESS8220	110VAC	600mA	3.0
ESS8230	230VAC	500mA	

*synchronisation only occurs when sounders are connected to the same power supply

Tones

Tone	Description	Stage 1	Stage 2	Stage 3
1	Industrial hooter (klaxon)	Tone 1	Tone 3	Tone 5
2	Trumpet horn – medium note	Tone 2	Tone 1	Tone 5
3	Trumpet horn – high note	Tone 3	Tone 1	Tone 5
4	Buzzer	Tone 4	Tone 2	Tone 5
5	Bell	Tone 5	Tone 1	Tone 2

Specifications:

Sound output: 121dB @1m at nominal voltage
Sound frequency: 5 Tones selectable by DIP switches (2nd and 3rd stage by terminals)
Protection: IP66
Temp rating (°C): -25 to +55
Rating: Continuous
Cable entry: 2 x M20
Construction: Flame retardant ABS, UV stabilized

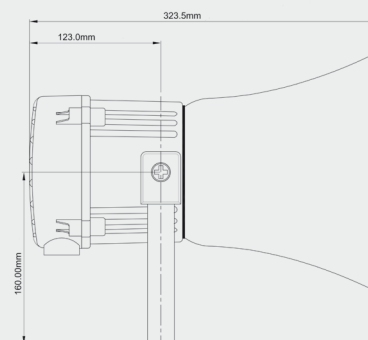
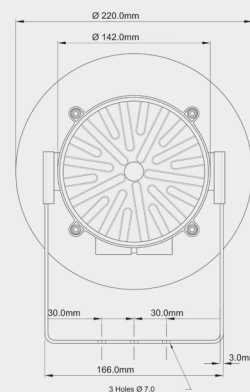

Sirengo Air Horns

- Compressed air operated high output horns
- Suitable for hazardous areas
- All metal construction
- Continuously rated



Order Code	Sound Frequency	Weight (kg)
KAMAH370	370Hz	2.8
KAMAH660	660Hz	2.4

Specifications:

Sound output: 138dB @ 1m
 Recommended pressure: 7 Bar (350-1000kpa)
 Air Connection: 19mm
 Construction: Cast aluminium

KAMAH370

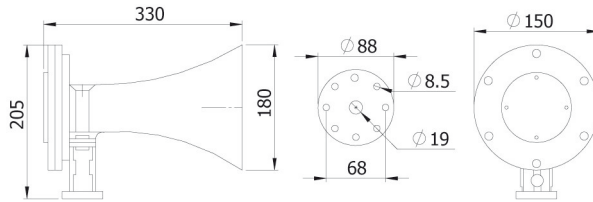

Dimensions in mm

KAMAH660

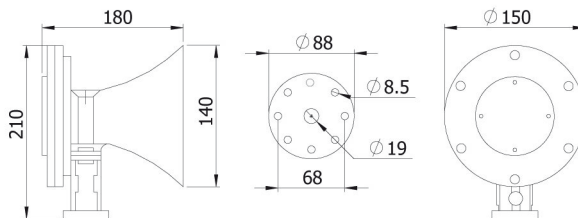

MB series



- Solenoid bell available with 4, 6 and 8 inch gongs (4 inch 12 and 24V bells are motor driven)
- Available in red or grey
- IP55 in 6 and 8 inch sizes when back box is used, 4 inch bells for indoor use only.

Order Code	Voltage	Current	Sound Output dB@1m	Weight (kg)
4 inch gong				
MB101012D*	12VDC	40mA	83dB	0.4
MB101024D*	24VDC	20mA		
MB100240A*	240VAC	35mA		
6 inch gong				
MB150012D*	12VDC	110mA	85dB	1.0
MB150024D*	24VDC	60mA		
MB150240A*	240VAC	40mA		
8 inch gong				
MB200012D*	12VDC	110mA	88dB	1.76
MB200024D*	24VDC	60mA		
MB200240A*	240VAC	40mA		

MBBOX*	Back mounting box 110x110x140mm
--------	---------------------------------

*Specify colour R = Red, G = Grey

Specifications:

Sound frequency: 2000-12,000Hz
 Protection: IP20 or IP55 in 6 and 8" sizes when installed with back box
 Temp rating (°C): -25 to +55
 Duty cycle: 60min max.
 Cable entry: Side and rear knockouts on back box
 Construction: Steel gong, die cast aluminium housing and back box

Dimensions in mm

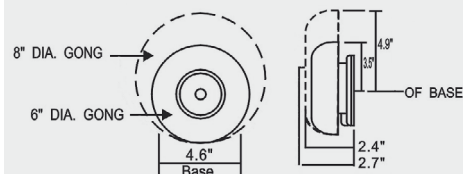
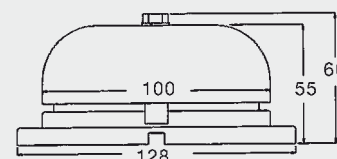

CEAD



- Industrial solenoid bell
- Wide choice of voltages
- Available in red or grey
- Double insulated
- IP66

Order Code*	Voltage	Current
CEAD – for AC voltage		
SIR8040125*	12VAC	860mA
SIR8040245*	24VAC	430mA
SIR8040485*	48VAC	250mA
SIR8040605*	60VAC	170mA
SIR8041105*	110VAC	90mA
SIR8042405*	240VAC	50mA
CEADEL – for DC voltage		
SIR8040121*	12VDC	600mA
SIR8040241*	24VDC	300mA
SIR8040481*	48VDC	160mA
SIR8040601*	60VDC	120mA
SIR8041101*	110VDC	60mA
SIR8042401*	240VDC	28mA

*Specify colour R = Red, G = Grey

Specifications:

Sound output: 98dB @ 1m DC versions
 100dB @ 1m AC versions
 Sound frequency: 2000-12000 Hz
 Duty cycle: Continuous
 Voltage tolerance: ±10%
 Protection: IP66
 Temp rating (°C): -30 to +50
 Cable entry: M16
 Construction: ABS and steel

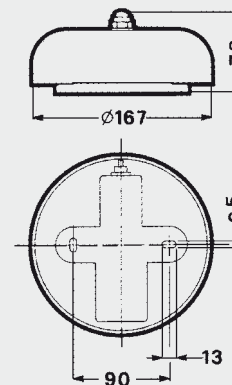

Dimensions in mm

LK100 Hand Operated Siren



- Hand wound siren with output up to 108dB
- Heavy duty aluminium or lightweight plastic versions
- Supplied with carry bag

Order Code	Description	Weight (kg)
LK100	Hand wound siren - aluminium	1.2
LK100P	Hand wound siren - ABS	0.6

Specifications:

Sound output: 108dB @ 1m
 Frequency: 550Hz nominal (depends on speed of rotation)
 Construction: Aluminium or ABS
 Weight: 1.2/0.6 Kg

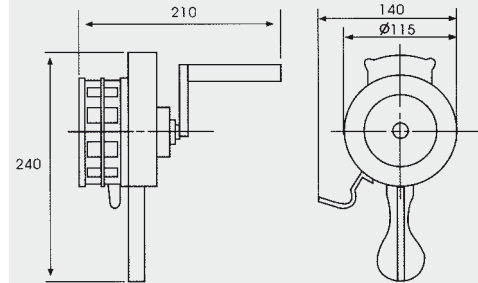

Dimensions in mm

LK120 Hand Operated Siren



- Hand wound siren with output up to 120dB
- Heavy duty aluminium construction
- Portable with stand

Order Code	Description	Weight (kg)
LK120	Hand wound siren	11

Specifications:

Sound output: 120dB @ 1m
 Frequency: 600Hz nominal (depends on speed of rotation)
 Construction: Aluminium siren with steel tube stand
 Weight: 1.2/0.6 Kg

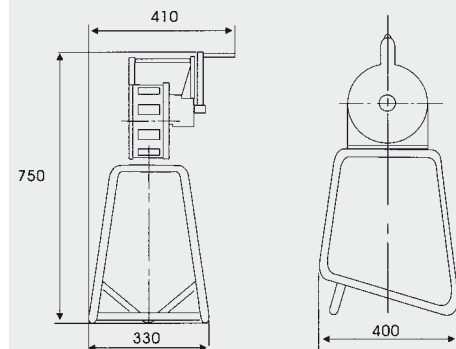

Dimensions in mm

EcoBlast PRO



- Rechargeable air horn
- High sound output up to 115dB
- Rechargeable from air compressor or bike pump etc
- Pressure "fuel" gauge fitted
- Supplied with carry strap
- Optional bracket for wall mounting

Order Code	Description	Weight (kg)
AIZ010	EcoBlast Pro	0.95
AIZ900	Wall mounting bracket	0.7

Specifications:

Operating pressure: Min 5psi to Max 90psi
 Sound output: Max 115dB @ 1m
 Autonomy: Approx. 200 blasts per charge
 Construction: ABS
 Dimensions (L x H x W): 280 x 230 x 160mm

MB010

- 10J Xenon strobe
- Synchronised flash or flip-flop mode on multi-beacon systems**
- IP67
- Stainless steel lens guard as standard



Order Code	Voltage	Current
ESS7202*	10-14VDC	1.45A
ESS7212*	20-28VDC	660mA
ESS7217*	42-54VDC	340mA
ESS7222*	115VAC ±10%	250mA
ESS7232*	230VAC ±10%	110mA

*Specify colour A = Amber, B = Blue, C = Clear, G = Green, R = Red

Specifications:

Light intensity:	183cd(e)
Flash energy:	10J
Flash rate:	60fpm
Protection:	IP67
Duty:	Continuous
Temp rating (°C):	-25 to +55
Cable entry:	2 x M20
Construction:	Flame retardant ABS housing, glass lens
Weight:	1.48kg

**synchronisation or flip-flop modes on multi-beacon systems on a single supply

MBL1

- Multifunction LED beacon
- 9 flash patterns
- 3 stage alarm, remotely selectable
- IP67
- Stainless steel lens guard as standard



Specifications:

Light intensity:	11cd(e)
Flash rate:	Multifunction – see list
Protection:	IP67
Duty:	Continuous
Temp rating (°C):	-25 to +55
Cable entry:	2 x M20
Construction:	Flame retardant ABS housing, glass lens
Weight:	1.48kg

Flash Patterns

Stage 1: [Selectable on board]	Stage 2: [Remotely selectable]	Stage 3: [Remotely selectable]
1 Static	1 Alternate Side Flash 1:1 2Hz	1 Double Strike Flash 2Hz
2 Rotating: Fast 1	2 Rotating: Fast 2	2 Static
3 Rotating: Fast 2	3 Double Strike Flash 2Hz	3 Static
4 Rotating: Slow 1	4 Alternate Side Flash 1:1 2Hz	4 Static
5 Rotating: Slow 2	5 Double Strike Flash 1Hz	5 Static
6 Double Strike Flash 1Hz	6 Alternate Side Flash 1:1 2Hz	6 Static
7 Single Strike Flash 2Hz	7 Rotating: Fast 2	7 Static
8 Double Strike Flash 2Hz	8 Rotating: Fast 2	8 Static
9 Alternate Side Flash 1:1 2Hz	9 Rotating: Fast 2	9 Static

Order Code	Voltage	Current
ESS7512*	10-50VDC	400mA @24VDC
ESS7513*	24VAC ±10%	380mA
ESS7522*	115VAC ±10%	140mA
ESS7532*	230VAC ±10%	70mA

*Specify colour A = Amber, B = Blue, G = Green, R = Red, Y= Yellow

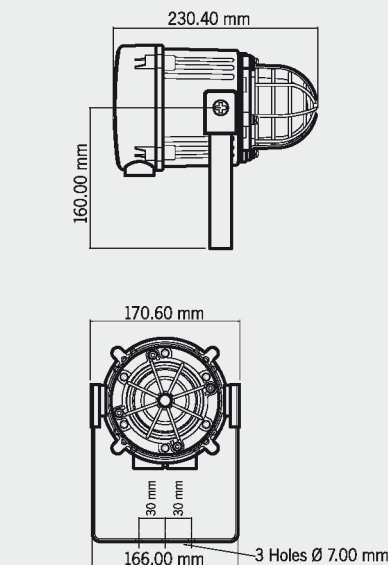

MCA112-05



- Electronic sounder with xenon beacon
- 45 tones, includes ISO tones to Australian Standards
- Automatic synchronisation on multi-sounder systems**
- Automatic synchronised flash or flip-flop alternating mode**
- Sounder and beacon controlled independently
- Volume control (122dB max. - 113dB min.)
- Three stage alarm (reverse polarity stage switching on DC units)
- IP67

Specifications:

Sound output:	Max 119dB @ 1m
Sound frequency:	45 tones see tone list on page 11-39
Flash energy:	5J
Light output:	51cd(e)
Flash rate:	60fpm
Protection:	IP67
Temp rating (°C):	-25 to +55
Cable entry:	2 x M20
Rating:	Continuous
Construction:	Flame Retardant ABS

**Synchronisation requires sounders to be connected to the same supply

Order Code	Voltage	Current Sounder	Current Beacon	Weight (kg)
ESS5410*	20-28VDC	200mA @ 24VDC	300mA	3.00
ESS5413*	24VAC±10%	500mA	350mA	3.50
ESS5415*	42-54VDC	120mA @ 48VDC	180mA	3.00
ESS5420*	115VAC ±10%	100mA	140mA	3.50
ESS5430*	230VAC ±10%	60mA	55mA	

*Specify colour A = Amber, B = Blue, G = Green, R = Red, Y = Yellow

MCA112-L1



- Electronic sounder with multifunction LED beacon
- 45 tones, includes ISO tones to Australian Standards
- Automatic synchronisation on multi-sounder systems**
- Sounder and beacon controlled independently
- Volume control (122dB max. - 113dB min.)
- Three stage alarm (reverse polarity stage switching on DC units)
- IP67

Specifications:

Sound output:	Max 119dB @ 1m
Sound frequency:	45 tones see tone list on page 11-39
Light output:	11cd(e)
Flash rate:	Multifunction - see list on page 11-54
Protection:	IP67
Temp rating (°C):	-25 to +55
Cable entry:	2 x M20
Rating:	Continuous
Construction:	Flame Retardant ABS

**Synchronisation requires sounders to be connected to the same supply

Order Code	Voltage	Current Sounder	Current Beacon	Weight (kg)
ESS5412*	10-30VDC	200mA @ 24VDC	400mA @ 24VDC	3.00
ESS5414*	24VAC±10%	500mA	380mA	3.50
ESS5416*	35-60VDC	120mA @ 48VDC	210mA	3.00
ESS5422*	115VAC ±10%	100mA	135mA	3.50
ESS5432*	230VAC ±10%	60mA	65mA	

*Specify colour A = Amber, B = Blue, G = Green, R = Red, Y = Yellow

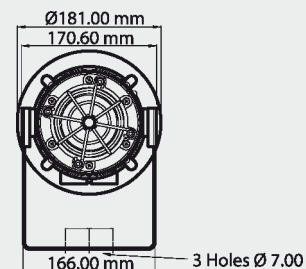
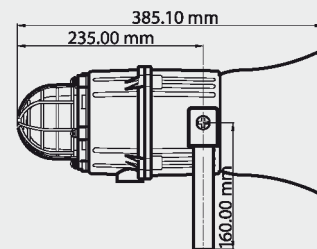

MA112



- Electronic sounder up to 119dB
- 45 tones, includes ISO tones to Australian Standards
- Automatic synchronisation on multi-sounder systems*
- Volume control (112dB max. - 100dB min on tone 2)
- Three stage alarm (reverse polarity stage switching on DC units)**
- IP67

Order Code	Voltage	Current	Weight (kg)
ESS5312	10-30VDC	200mA @ 24VDC	2.50
ESS5313	24VAC±10%	500mA	3.00
ESS5316	35-60VDC	120mA @ 48VDC	2.50
ESS5321	115VAC ±10%	100mA	3.00
ESS5331	230VAC ±10%	60mA	

Specifications:

Sound output: Max 119dB @ 1m
 Sound frequency: 45 tones see tone list on page 11-39
 Protection: IP67
 Temp rating (°C): -25 to +55
 Cable entry: 2 x M20
 Rating: Continuous
 Construction: Flame retardant ABS

*Synchronisation requires sounders to be connected to the same supply

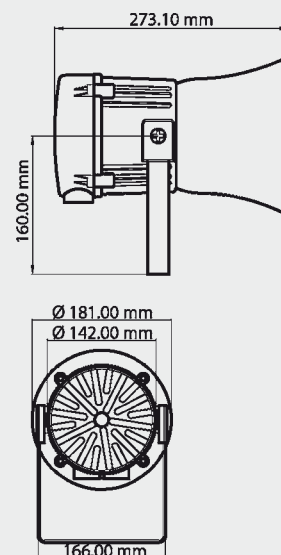

MA121



- Electronic sounder up to 126dB
- 45 tones, includes ISO tones to Australian Standards
- Automatic synchronisation on multi-sounder systems*
- Volume control (121dB Max. - 112dB min. on tone 2)
- Three stage alarm (reverse polarity stage switching on DC units)**
- IP67

Order Code	Voltage	Current	Weight (kg)
ESS5212	10-30VDC	950mA @ 24VDC	2.50
ESS5213	24VAC±10%	1.00A	3.00
ESS5216	35-60VDC	600mA @ 48VDC	2.50
ESS5221	115VAC ±10%	240mA	3.00
ESS5231	230VAC ±10%	120mA	

Specifications:

Sound output: Max 126dB @ 1m
 Sound frequency: 45 tones see tone list on page 11-39
 Protection: IP67
 Temp rating (°C): -25 to +55
 Cable entry: 2 x M20
 Rating: Continuous
 Construction: Flame retardant ABS

*Synchronisation requires sounders to be connected to the same supply

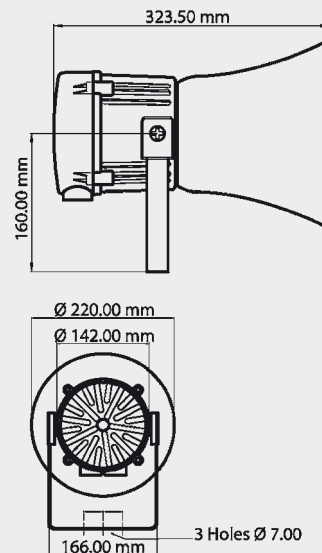

ML15

- 15W loud speaker
- Available with 8Ω or 16Ω coil or with 100V line transformer
- 100V line tapplings
- IP67



Order Code	Impedance	Weight (kg)
ESS5608	8 ohm	2.20
ESS5616	16 ohm	
ESS5620	100V line	2.60

Specifications:

Power: 15W RMS
Sound output: Max 118dB @ 15W @1m
Low impedance: 8 ohm or 16 ohm
100V line tapplings: 15W/7.5W/3W/1W
Dispersion: 120° @ 1kHz, 32° @4kHz
Frequency range: 400Hz to 8kHz
Line monitoring: 2.2uF (transformer version)
 470uF (impedance version)

Protection: IP67
Temp rating (°C): -25 to +55
Cable entry: 2 x M20
Rating: Continuous
Construction: Flame retardant ABS

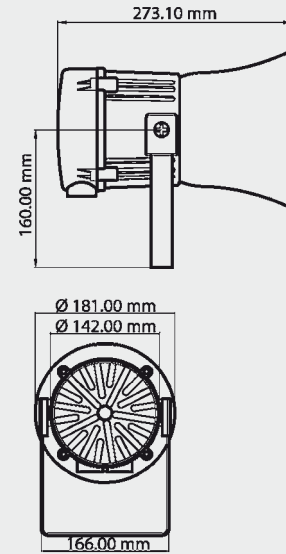

ML25

- 25W loud speaker
- Available with 8Ω or 16Ω coil or with 100V line transformer
- 100V line tapplings
- IP67



Order Code	Impedance	Weight (kg)
ESS5708	8 ohm	2.50
ESS5716	16 ohm	
ESS5720	100V line	3.00

Specifications:

Power: 25W RMS
Sound output: Max 121dB @ 15W @1m
Low impedance: 8 ohm or 16 ohm
100V line tapplings: 25W/12.5W/6W/2W
Dispersion: 130° @ 1kHz, 32° @4kHz
Frequency range: 300Hz to 8kHz
Line monitoring: 2.2uF (transformer version)
 470uF (impedance version)

Protection: IP67
Temp rating (°C): -25 to +55
Cable entry: 2 x M20
Rating: Continuous
Construction: Flame retardant ABS

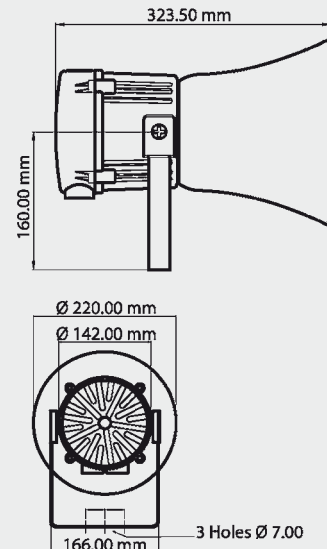

B450

- Traffic control, for loading bays, doors and gates
- Filament or LED bulbs, and LED array versions
- Supplied as individual units or in sets of 2 or 3
- Customised control options available
- IP65



Specifications:

Protection:	IP65
Duty:	Continuous
Temp rating (°C):	-25 to +50
Cable entry:	2 x M20
Construction:	Polycarbonate (powder coated steel boxes)
Weight:	0.37kg (individual units)

Order Code	Voltage	Current
B450TLA – LED array 89cd(e)		
ESSB450TLA030B*	10-30VDC	130mA
ESSB450TLA230B*	90-230VAC	10-30mA
ESSB450B2TLA030B**	2 x 10-30VDC signals mounted on box	
ESSB450B2TLA230B**	2 x 90-230VAC signals mounted on box	
ESSB450B3TLA030B***	3 x 10-30VDC signals mounted on box	
ESSB450B3TLA230B***	3 x 90-230VAC signals mounted on box	

*Specify colour A = Amber, G = Green, R = Red (top to bottom)

B450TSB – filament or LED bulbs 32cd(e) E27 25W max**

ESSB450TSB250B*	12-240VAC/DC	25W max
ESSB450B2TSB250B**	2 x signals mounted on box	
ESSB450B3TSB250B***	3 x signals mounted on box	

B450TDB – filament 24cd(e) 2 x E14 15W max**

ESSB450TDB250B*	12-240VAC/DC	2 x 15W max
ESSB450B2TDB250B**	2 x signals mounted on box	
ESSB450B3TDB250B***	3 x signals mounted on box	

*Specify colour A = Amber, B = Blue, C = Clear, G = Green, R = Red (top to bottom)

**Bulbs must be ordered separately

Note: Box dimensions – 2 light 400h x 200w x 120d
3 light 500h x 200w x 120d

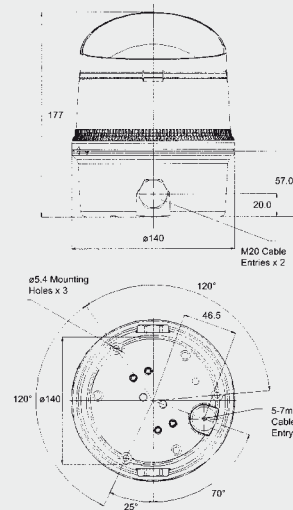

Dimensions in mm

Mounting Bracket

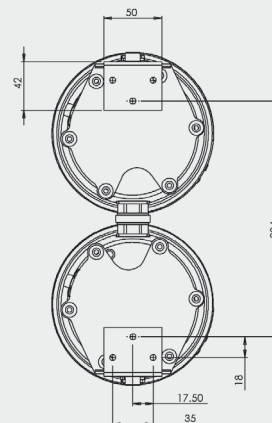
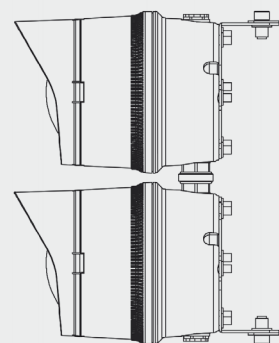

Accessories and Spare Parts

Order Code	Description
ESS9BMB450TS	Mounting bracket for single units
ESS9BMB450TM	Mounting bracket for multiple units
ESS9BGS***25C27	E27 Bulb 25W
ESS9B1015***	E14 Bulb 15W

*Specify voltage 024 = 24V, 110 = 110V, 240 = 240V

100mm Traffic Lights



- 100mm LED traffic light modules and housings
- Modules with 31 High output LED's
- 80,000 hour life (approximate)
- 1, 2 and 3 aspect housing
- 24VDC and 85-265VAC power supply options
- IP65
- Meets EN12368
- Customised control options available

Order Code	Aspect/Colour	Voltage	Weight (kg)
------------	---------------	---------	-------------

2 and 3 aspect traffic light

25JD1003251DCRG	2 aspect Red/Green	24VDC	3.14
25JD1003251ACRG	2 aspect Red/Green	85-265 VAC	3.14
25JD1003351DCRGY	3 aspect Red/Yellow/Green	24VDC	4.2
25JD1003351ACRGY	3 aspect Red/Yellow/Green	85-265 VAC	4.2

100mm LED module only

25DXJD100554DCR	Red LED module	24VDC	0.08
25DXJD100554DCA	Yellow LED module	24VDC	0.08
25DXJD100554DCG	Green LED module	24VDC	0.08
25DXJD100554ACR	Red LED module	85-265 VAC	0.08
25DXJD100554ACA	Yellow LED module	85-265 VAC	0.08
25DXJD100554ACG	Green LED module	85-265 VAC	0.08

Blue and White LED modules are available on request subject to minimum order quantities

Specifications:

Light source:	31 x 5mm LED
Light output:	Red/Yellow >150Cd(e) Green >220Cd(e)
Wave length:	Red- 620-630 nm Yellow – 590-594 nm Green – 503-508 nm
Power consumption:	<5W
Protection:	IP65
Duty:	Continuous
Temp rating (°C):	-40 to +80
Cable entry:	Trough housing bracket
Construction:	UV resistant polycarbonate

Compliance and standards:

Compliance with CE, EN12368, RoHS

2 Aspect

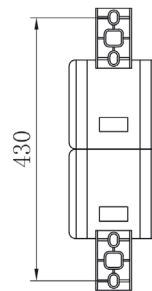
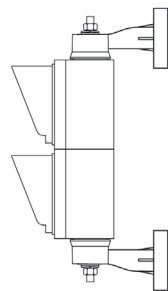
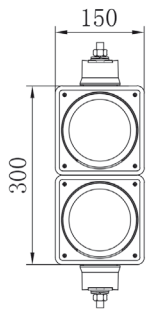

Dimensions in mm

3 Aspect

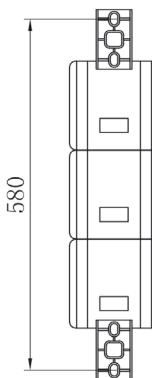
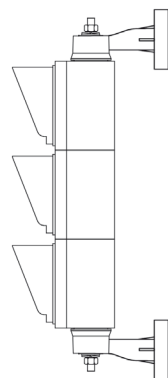
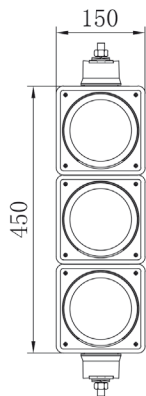

200mm Traffic Lights



- 200mm LED traffic light modules and housings
- Modules with 31 High output LED's
- 80,000 hour life (approximate)
- 1, 2 and 3 aspect housing
- 24VDC and 85-265VAC power supply options
- IP65
- Meets EN12368
- Customised control options available

Order Code	Aspect/Colour	Voltage	No. LED's	Weight (kg)
------------	---------------	---------	-----------	-------------

2 and 3 aspect traffic light

25JD2003251DCRG	2 aspect Red/Green	24VDC	90/90	5.5
25JD2003251ACRG	2 aspect Red/Green	85-265 VAC	90/90	5.5
25JD2003351DCRGY	3 aspect Red/Yellow/Green	24VDC	90/90/90	8.0
25JD2003351ACRGY	3 aspect Red/Yellow/Green	85-265 VAC	90/90/90	8.0

200mm LED module only

25DXJD200552DCR	Red LED module	24VDC	90	0.75
25DXJD200552DCY	Yellow LED module	24VDC	90	0.75
25DXJD200552DCG	Green LED module	24VDC	90	0.75
25DXJD200552ACR	Red LED module	85-265 VAC	90	0.75
25DXJD200552ACY	Yellow LED module	85-265 VAC	90	0.75
25DXJD200552ACG	Green LED module	85-265 VAC	90	0.75
25DXCD200552ADC	Red X LED module	24VDC	45	0.75
25DXFX200552DCR	Red LED module	24VDC	36	0.75
25DXFX200552DCY	Yellow LED module	24VDC	36	0.75
25DXFX200552DCG	Green LED module	24VDC	36	0.75
25DXFX200552ACR	Red LED module	85-265 VAC	36	0.75
25DXFX200552ACY	Yellow LED module	85-265 VAC	36	0.75
25DXFX200552ACG	Green LED module	85-265 VAC	36	0.75
25DXCD200552DC	Red X/Green arrow LED module	24VDC	45/36	0.75
25DXCD200552AC	Red X/Green arrow LED module	85-265 VAC	45/36	0.75
25DXRX200552DCG	Walking green man module	24VDC	96	0.75
25DXRX200552ACG	Walking green man module	85-265 VAC	96	0.75
25DXRX200552DCR	Red man module	24VDC	66	0.75
25DXRX200552ACR	Red man module	85-265 VAC	66	0.75

Polycarbonate empty housing

25PCH200	1 aspect housing with mounting accessories	2.2
25PCH200X2	2 aspect housing with mounting accessories	4.0
25PCH200X3	3 aspect housing with mounting accessories	5.75

To order non-standard combinations or arrows, crosses, and pedestrian symbols, order the modules and housings separately. Blue, White, bicycle and countdown modules are available on request subject to minimum order quantities.

Specifications:

Light source:	6.5mm LEDs
Light output:	Red >400Cd(e) Green/Yellow >600Cd(e)
Wave length:	Red- 620-630 nm Yellow – 590-594 nm Green – 503-508 nm
Power consumption:	<9W
Protection:	Housing - IP54 (modules IP65)
Duty:	Continuous
Temp rating (°C):	-40 to +80
Cable entry:	Trough housing bracket
Construction:	UV resistant polycarbonate

Compliance and standards:

Compliance with CE, EN12368, RoHS

2 Aspect

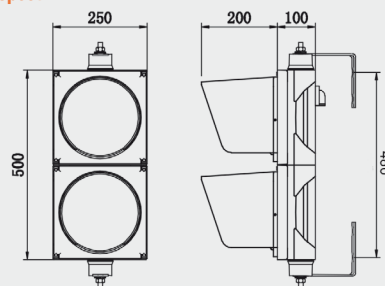

Dimensions in mm

3 Aspect

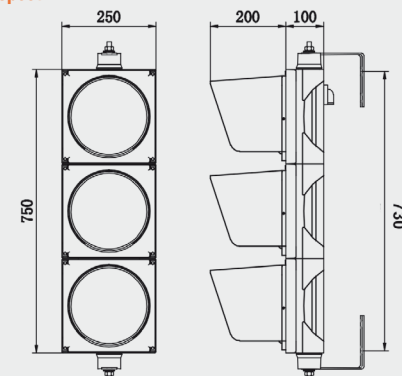

LEDEO Low Intensity Type B



29LBIB11..C

- Steady light red LED beacon for aircraft obstruction warning on obstacles up to 45m height
- Type B > 32Cd meets ICAO and CASA standards for low intensity obstacle lights (note where lighting is a mandatory requirement by CASA a twin fitting must be used)
- Life time > 10 years
- Low current consumption < 6W
- Integrated photocell and alarm contact
- Integrated lightning protection
- Box mounting version allows light position adjustment
- IP68
- Options include, battery backup, solar and control options.



29LBIB11..Z

Order Code	Description	Voltage	Current	Weight (kg)
29LBIB11AC	Single light type B	24VDC	200mA	1.5
29LBIB11MC	Single light type B	110-230 VAC	23mA	1.5
29LBIB11AZ	Single light type B box mount	24VDC	210mA	7
29LBIB11MZ	Single light type B box mount	240VAC	23mA	7
29LBIBTWB	Twin light type B box mount (CASA)	48VDC	120mA	8
29LBIBTWMB	Twin light type B box mount (CASA)	110-230 VAC	280mA	8



29LBIBTW..

Specifications:

Light source: Red LEDs
 ≥ 32Cd(p)
 Light intensity: 360° horizontal, 10° vertical
 IP68
 Protection: 240km/h
 Wind rating: Continuous
 Duty: -55 to +55
 Temp rating (°C): 2m cable provided
 Cable entry: (2 x M20 entries on box version)
 Mounting: M6 bolts (M8 screw for box version)
 Mounting box dimensions: 325 x 246 x 160mm
 Construction: Aluminium body, polycarbonate lens with bird spike, zamak box.

Compliance and standards:

Compliance with CE, EN60947-1, ICAO, FAA, CASA

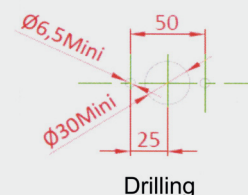
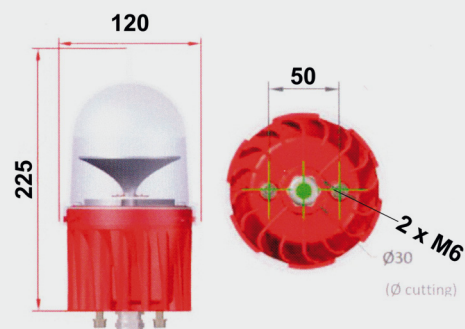

Drilling

Dimensions in mm

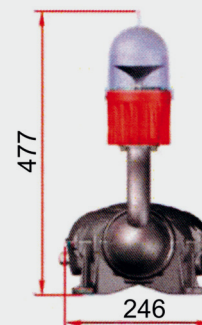
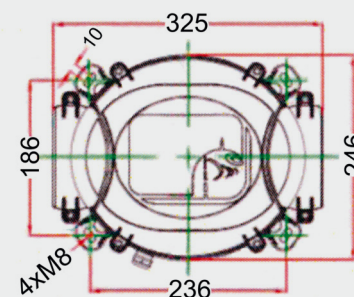

Accessories and Spare Parts

Order Code	Description
29LBIBPOT	Support bracket for single light 316 SS

LEDEO Medium Intensity Type A/B/C

- Type A –flashing white
Type B - flashing red
Type C- steady red
- For aircraft obstruction warning on obstacles between 45m and 150m height
- Meets ICAO and CASA standards for medium intensity obstacle lights
- Life time > 10 years
- Low current consumption < 90W (average 45W)
- Integrated photocell and alarm contact
- Wired synchronisation with adjacent beacons.
- Integrated lightning protection
- Box mounting version allows light position adjustment.
- IP68
- Options include, battery backup, solar and control options.



Type A



Type B and C

Order Code	Description	Voltage	Current	Weight (kg)
29LMIA11BB	Type A white flashing 2000/20000Cd	48VDC	4.2A	17
29LMIA11MB	Type A white flashing 2000/20000Cd	110-230 VAC	0.9A	17
29LMIB11BB	Type B red flashing 2000Cd (night)	48VDC	1.3A	16
29LMIB11MB	Type B red flashing 2000Cd (night)	110-230 VAC	300mA	16
29LMIC11BB	Type C red steady 2000Cd (night)	48VDC	350mA	16
29LMIC11MB	Type C red steady 2000Cd (night)	110-230 VAC	300mA	16

Specifications:

Light source: White or Red LEDs
 Light intensity: Type A – Flashing 20,000Cd day/2,000Cd night (white LED)
 Flash rate- 20-60fpm
 Type B – Flashing 2,000Cd night (red LED) Flash rate- 20-60fpm
 Type C – Steady 2,000Cd night (red LED)
 360° horizontal, 3° vertical
 IP68
 Protection: IP68
 Wind rating: 240km/h
 Duty: Continuous
 Temp rating (°C): -55 to +55
 Cable entry: 2 x M20
 Mounting: M6 bolts (M8 screw for box version)
 Mounting box dimensions: 325 x 246 x 160mm
 Construction: Aluminium body, polycarbonate lens, zamak box.

Compliance and standards:

Compliance with CE, EN60947-1, ICAO, FAA, CASA

