

FF81P - FF91P - FF84 Liquid Flow Switch

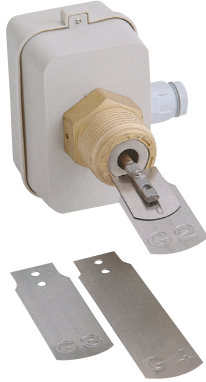

- Suitable for the control of fluid in pipes up to 10"
- Stainless steel or non-toxic plastic paddles
- Paddle length can be cut to suit pipe size
- Adjustable set point

Model	Pipe Ø (inch)	Minimum Flow litre/sec		Maximum Flow litre/sec	
		Increasing flow	Decreasing flow	Increasing flow	Decreasing flow
FF81P	1	0.26	0.16	0.58	0.53
	2	0.87	0.65	1.65	1.74
	3	1.85	1.3	3.49	3.27
	4	2.39	1.85	5.56	5.23
FF91P	½	0.13	0.08	0.29	0.26
	1½	0.29	0.24	0.87	0.79
	2	0.8	0.6	1.7	1.6
FF84	6	4.7	3.4	9	8.5
	8	12.9	10.7	26	25.2
	10	26.5	22	43.5	41

Order Code	Description	Paddle	Pipe connection	Weight (kg)
FANFF81P	Liquid flow switch 1 to 4" pipes	Non-toxic plastic	G 1"	0.34
FANFF91P	Liquid flow switch ½ to 2" pipes	Non-toxic plastic	G ½"	0.25
FANFF84	Liquid flow switch 6 to 10" pipes	301 stainless steel	G 1"	0.67

Specifications:

Switch rating: SPDT 10A 250VAC (AC-12), 3A AC15, 0.2A DC
 Max working pressure: 10Bar
 Max working temp: FF84 - 110°C, FF81P/91P - 100°C
 Max body temp: 50°C
 Cable entry: 3/8"
 Protection: IP54
 Construction: anti-shock thermoplastic housing, brass connection

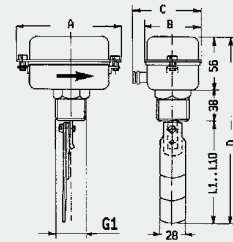

	FF81	FF84
A	105	98
B	62	54
C	80	72
D	204	354
G	G1	G1

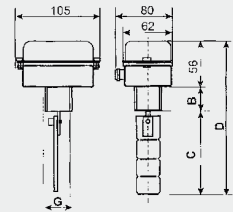

	FF81P	FF91P
B	38	27
C	110	60
D	204	143
G	G1	G1/2

Dimensions in mm

SF1800 Liquid Flow Switch



- Suitable for the control of fluid in pipes
- 304 stainless steel (optional 316 stainless steel)
- Paddle length can be cut to suit pipe size
- IP65

Pipe Ø (inch)	Flow litre/sec	
	Switch On	Switch Off
1	22	18
1-½	63	45
2	81	54
3	100	72

Order Code	Description	Pipe connection	Weight (kg)
FINFS80	Liquid flow switch 1 to 8" pipes	1" NPT	0.85

Specifications:

Switch rating: SPDT 1A 240V a.c.
 Max working pressure: 25Bar
 Working temp: -30 to 150°C
 Cable entry: ½" NPT
 Protection: IP65
 Construction: Aluminium head, 304 stainless steel and Teflon connection, 304 stainless steel paddle

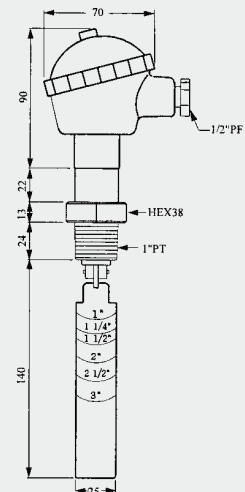

Dimensions in mm